

IN9395

External Shield - Sliding Door

THANK YOU FOR PURCHASING A VAN GUARD EXTERNAL SHIELD

SUITS THE FOLLOWING MODELS

Vehicle:

Citroen Dispatch 2016 on (L2, L3)

Fiat Scudo 2022 on (L1, L2)

Peugeot Expert 2016 on (L2, L3)

Toyota Proace 2016 on (L2, L3)

Vauxhall Vivaro 2019 on (L1, L2)

Door:

Sliding - Driver's

⊗ Indicates approximate placement of shield

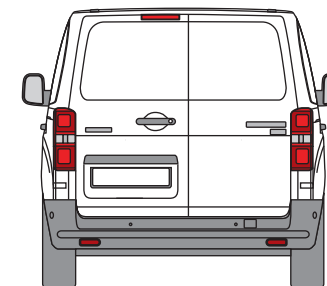
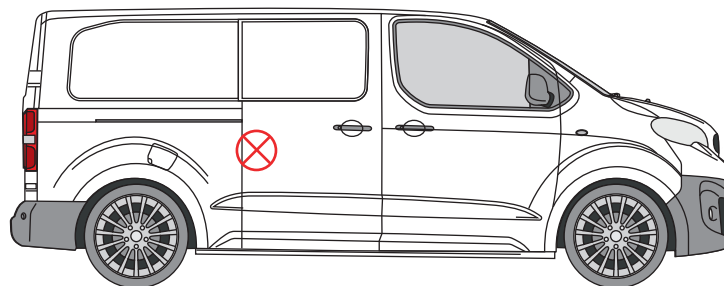

CAUTION

PLEASE TAKE THE TIME TO READ THROUGH THE IMPORTANT INFORMATION BELOW BEFORE PROCEEDING TO FIT THIS PRODUCT



FAILURE TO TAKE NOTICE OF THE FOLLOWING INFORMATION MAY RESULT IN DAMAGE TO THE VEHICLE.



Important: Follow the instructions and all measurements carefully. Double check measurements before making any cuts. Drawings are for guidance only. Every effort has been made to ensure the accuracy of the instructions provided however Van Guard Accessories Ltd accepts no liability for any inaccuracies of either the drawings provided or vehicle variations. All bare metal should be treated with a manufacturer approved anti-corrosion compound and no liability is accepted for any incorrect installation or corrosion to body panels or within cavities. It is the sole responsibility of the installer to ensure the suitability of both the vehicle and of the supplied parts before installation is started. No liability is accepted for the fitting of the products.

This FITTING INSTRUCTION is the property of VAN GUARD ACCESSORIES LTD. and must not be used for manufacturing purposes, copied nor communicated in any way to third parties without written permission from VAN GUARD ACCESSORIES LTD.
IN9395_B (CN:00173)

Van Guard Accessories Ltd
Fair Oak Close, Exeter Airport Business Park,
Exeter, Devon, EX5 2UL
www.van-guard.co.uk

SUPPLIED COMPONENTS

AS3648 X1
(SHIELD)

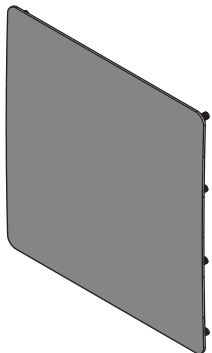

FX4004 X6
(M6 NYLOC)

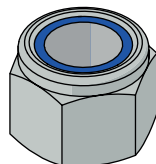

MA6164 X1
(RUBBER GASKET)

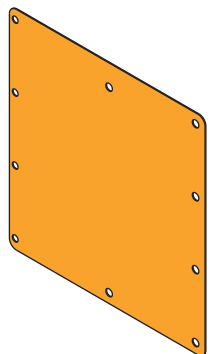

FX4013 X3
(M6 WASHER - LARGE)

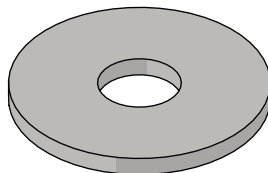

FX4111 X4
(M5 NYLOC)

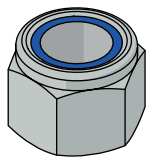

FX4017 X7
(M6 WASHER - SMALL)

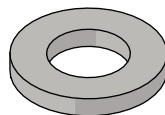

Wear the appropriate protective equipment (safety glasses & gloves) while fitting this product.



Dispose of packaging materials responsibly - Do not dispose until you have checked all parts and fixings are present.

FITTED IMAGE



IMPORTANT NOTE

This product is not suitable for the L1 variant of the Citroen Dispatch / Peugeot Expert / Toyota Pro-Ace. Check you are not fitting to this variant before proceeding.

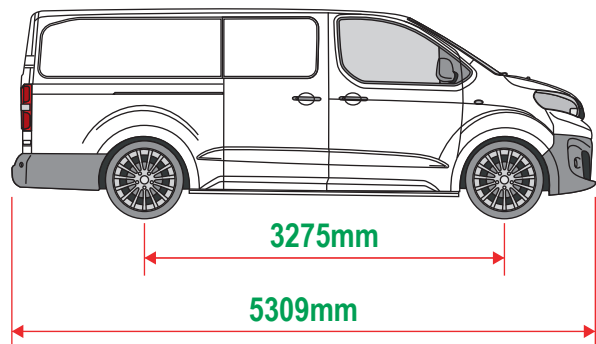
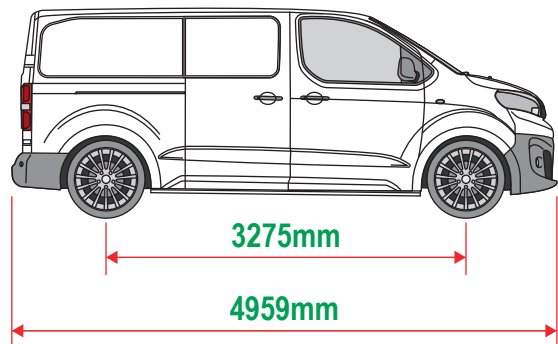
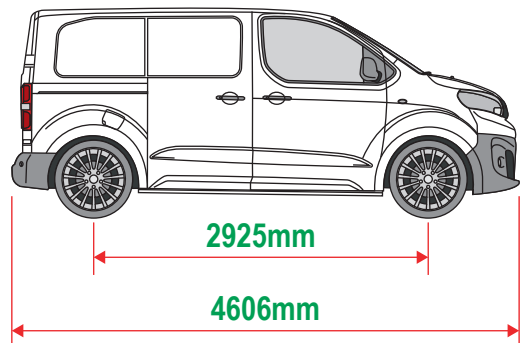

1. ACCESS INSIDE OF DOOR

Remove the plastic panel to the rear edge of the side loading door. There are two clips to the forward edge, one to the top and one to the bottom. The rear edge is hooked over the metal.



2. GASKET NOTE

Before proceeding to the next step, it's important to note that the gasket is handed with the holes running down the sides offset difference distances. When using the gasket as a template in the next step, ensure that you position the gasket the correct way with the 7mm offset holes running down the edge of the door as shown.

7MM 11.5MM

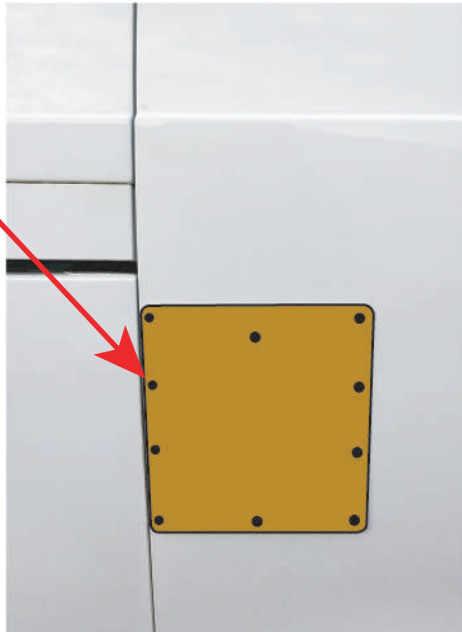
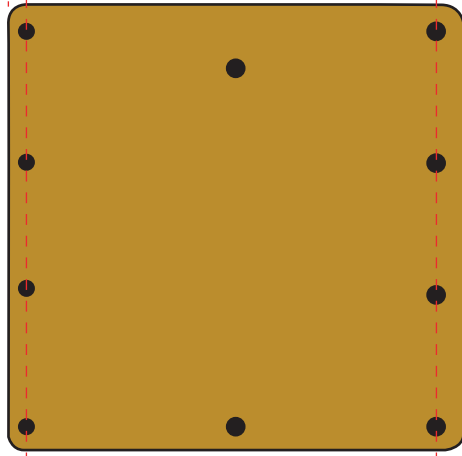

3. POSITIONING THE SHIELD

1. Protect the area of the door where the shield will be fitted with masking tape.
2. Mark 183mm from the window aperture as shown. Use the rubber gasket as a template to mark the hole positions with the top of the gasket at the mark. Make sure the gasket is orientated correctly with the yellow backing facing you and ensure it is running parallel with the rear of the sliding door. The gasket is profiled 1.5mm smaller than the shield so it needs to be offset 1.5mm from the edge of the door.
3. Mark down the ten hole centres. Then **with the door open**, carefully drill the fixings holes with as short a drill bit as possible to avoid hitting anything behind the door. Use a 4mm pilot then open the 6 x M6 holes to 8mm and the 4 x M5 holes to 7mm. Remove any swarf and treat bare metal with anti-corrosion spray.

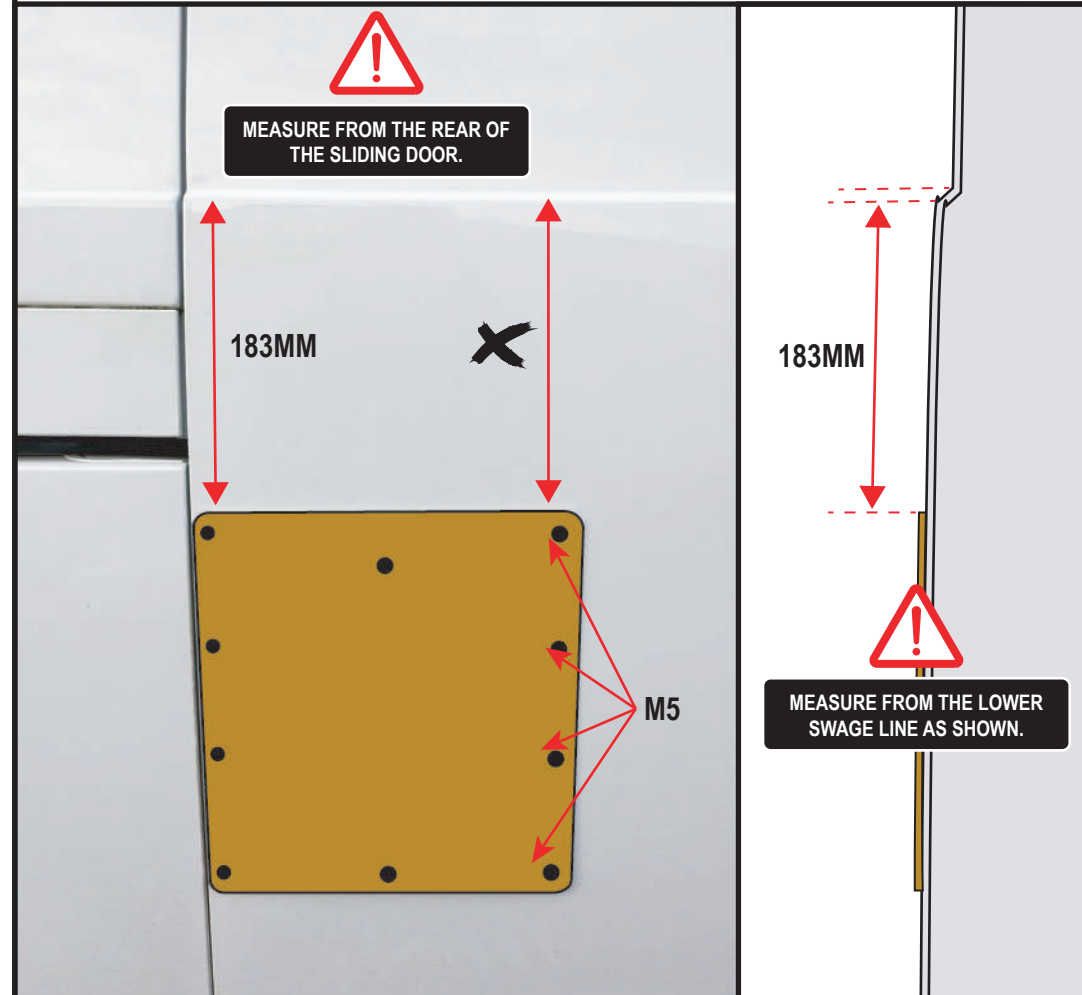

4. RUBBER GASKET & WASHER SIZES

1. Stick the rubber gasket to the outer shield and then place the shield in position.
2. Place the three large washers over the studs highlighted below from the interior of the vehicle.
3. Place the small washers over the remaining studs from the interior of the vehicle.



THE THREE LARGE WASHERS SHOULD BE PLACED ON THESE STUDS FROM THE INTERIOR.

5. SECURING THE SHIELD

Secure in place with the 4 x M5 nyloc nuts on the edge of the door and the 6 x M6 nyloc nuts on the remaining studs. **Take care not to overtighten the nuts, tighten M5 to 4Nm & M6 to 9Nm.** Once fitted, refit the door panel.

