

IN9445

Loom Guard - Cab Doors

THANK YOU FOR PURCHASING A VAN GUARD LOOM GUARD

SUITS THE FOLLOWING MODELS

Vehicle:
Ford Transit Custom 2023-

Door:
Cab - Driver's / Passenger's

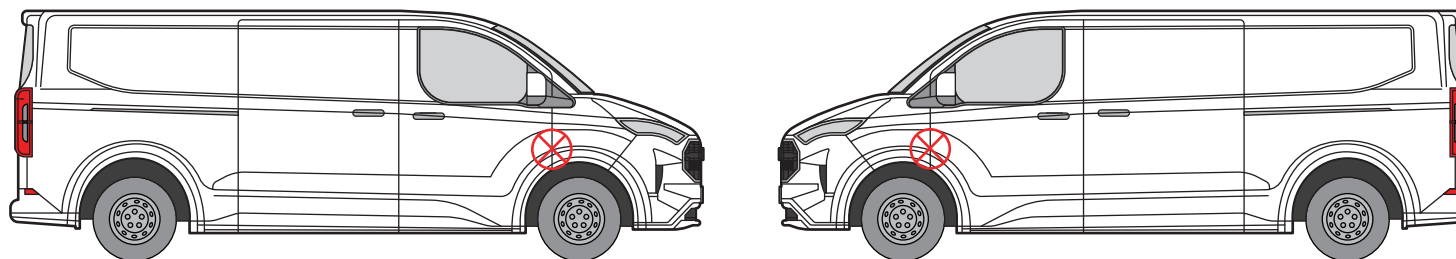

⊗ Indicates approximate placement of guard



CAUTION

PLEASE TAKE THE TIME TO READ THROUGH THE IMPORTANT INFORMATION BELOW BEFORE PROCEEDING TO FIT THIS PRODUCT



FAILURE TO TAKE NOTICE OF THE FOLLOWING INFORMATION MAY RESULT IN DAMAGE TO THE VEHICLE.



Important: Follow the instructions and all measurements carefully. Double check measurements before making any cuts. Drawings are for guidance only. Every effort has been made to ensure the accuracy of the instructions provided however Van Guard Accessories Ltd accepts no liability for any inaccuracies of either the drawings provided or vehicle variations. All bare metal should be treated with a manufacturer approved anti-corrosion compound and no liability is accepted for any incorrect installation or corrosion to body panels or within cavities. It is the sole responsibility of the installer to ensure the suitability of both the vehicle and of the supplied parts before installation is started. No liability is accepted for the fitting of the products.

This FITTING INSTRUCTION is the property of VAN GUARD ACCESSORIES LTD. and must not be used for manufacturing purposes, copied nor communicated in any way to third parties without written permission from VAN GUARD ACCESSORIES LTD.
IN9445_B (CN:01319)

Van Guard Accessories Ltd
Fair Oak Close, Exeter Airport Business Park,
Exeter, Devon, EX5 2UL
www.van-guard.co.uk

SUPPLIED COMPONENTS

ME3671 X1
(DRIVER'S DOOR LOOM GUARD)

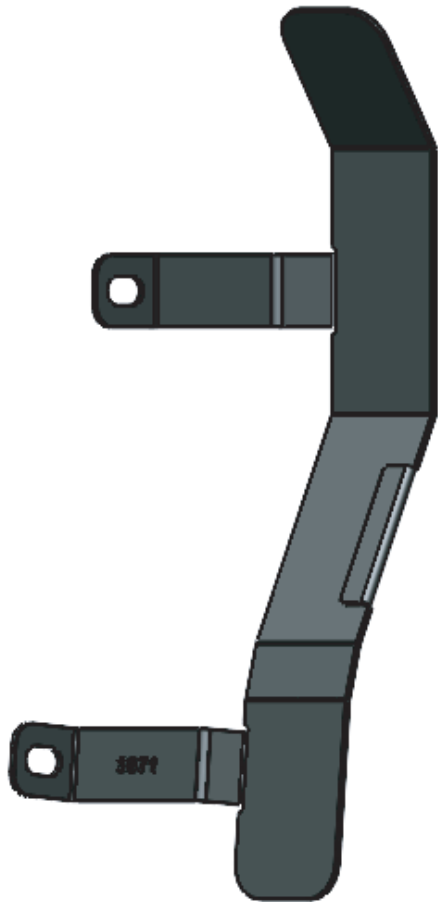

ME3672 X1
(PASSENGER'S DOOR LOOM GUARD)

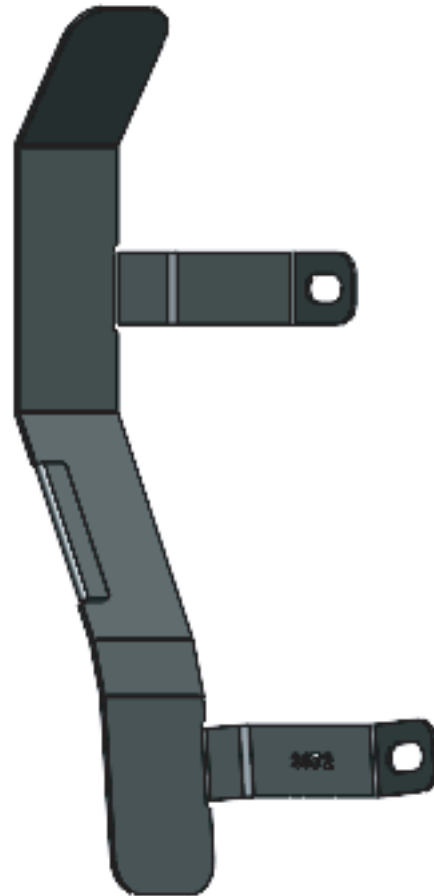

Wear the appropriate protective equipment (safety glasses & gloves) while fitting this product.



Dispose of packaging materials responsibly - Do not dispose until you have checked all parts and fixings are present.

FITTED IMAGE



1. UNDO BOLT

Open the cab door to reveal the bolts, Remove the bolts, then pull up the wiring loom to allow easy access to the hex bolt. Unscrew the two bolts from behind, as shown in the image below. **Retain both bolts for re-fitting.**



2. FITTING THE LOOM GUARD

Slide in the loom guard under the loom until the holes align with the bolt holes in the body.



IMAGE SHOWS PART ME3672 BEING FITTED TO PASSENGER SIDE.

3. REDO BOLT

Re-fit and tighten the removed bolts.



4. CHECK FIT

Check the loom guard is fitted correctly as shown below.

