

IN8045

Rear Door Ladder - Volkswagen Transporter T5 / T6

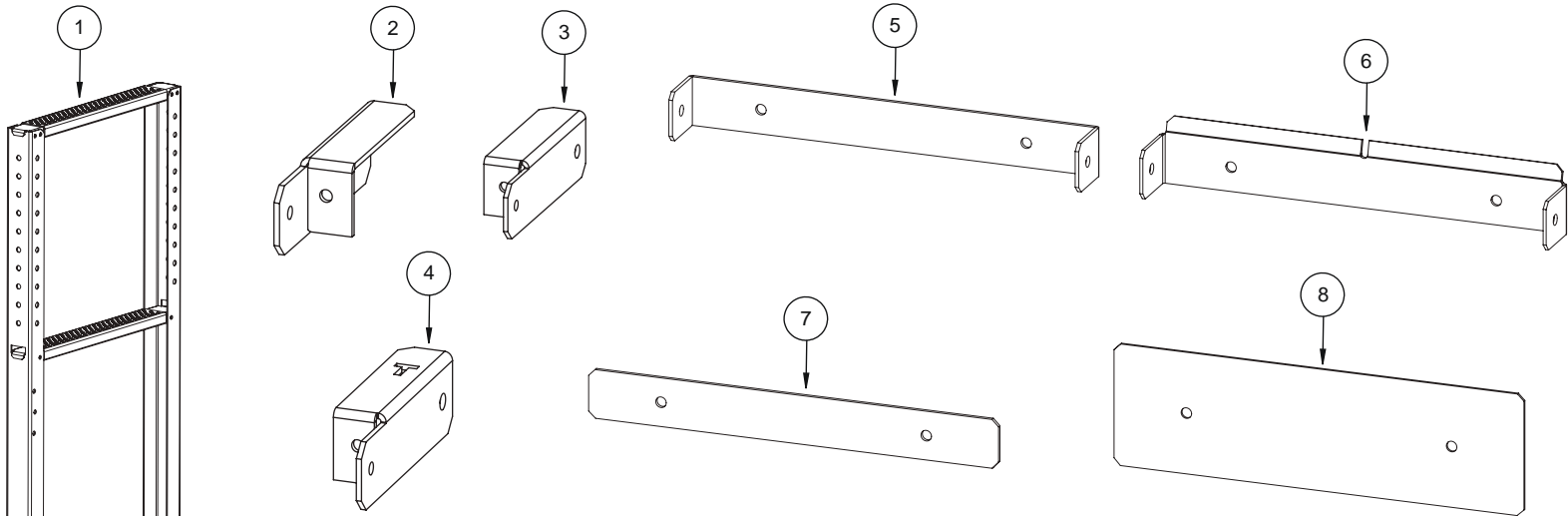
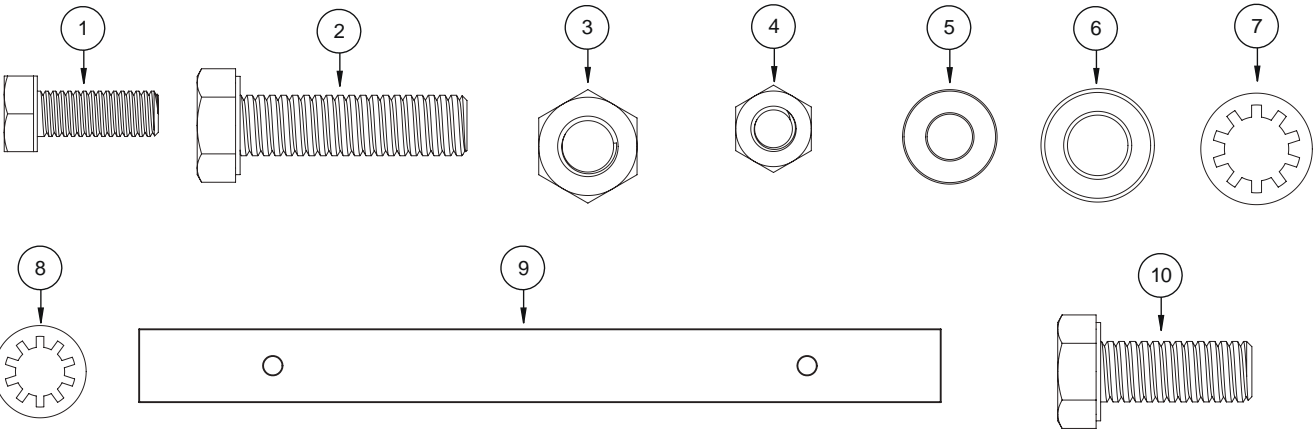

SUPPLIED COMPONENTS		#	DESCRIPTION	QTY
	1	1	REAR DOOR LADDER	1
	2	2	SPACER BRACKET [LEFT HAND]	2
	3	1	SPACER BRACKET [RIGHT HAND]	1
	4	1	EXTENDED SPACER BRACKET	1
	5	1	OUTER FIXING BRACKET (TOP)	1
	6	1	OUTER FIXING BRACKET (BOTTOM)	1
	7	1	INTERNAL FIXING PLATE (BOTTOM)	1
	8	1	INTERNAL FIXING PLATE (TOP)	1
SUPPLIED FIXING KIT		#	DESCRIPTION	QTY
	1	8	M6x16 HEX BOLT	8
	2	4	M8x30 HEX BOLT	4
	3	8	M8 NUT	8
	4	8	M6 FULL NUT	8
	5	16	M6 WASHER	16
	6	16	M8 WASHER	16
	7	8	M8 SHAKEPROOF	8
	8	8	M6 SHAKEPROOF	8
	9	2	H330 RUBBER PAD	2
	10	4	M8x20 HEX BOLT	4

TOOLS REQUIRED: 10mm & 13mm SPANNER / RATCHET, 8.5mm DRILL BIT, DRILL

IMPORTANT NOTES

1. Do not install the ladder in front of or below rear bumper.
2. Always wear safety glasses when drilling.
3. Ladder only to be used when rear doors are fully closed.
4. Ladder has a maximum weight limit of 100kg.
5. Read through the instructions before fitting the ladder.

Whilst every effort has been made to ensure all of our products can be safely fitted, we cannot accept any liability for damage caused either by the fitting or improper use of our products. Please check that no pipes, tanks, wiring etc... will obstruct any drilling operation and the weight restriction limit is adhered to.



- 1 Please read the important notes to the left before fitting this product.

Stick rubber pads to the two outer fixing brackets.

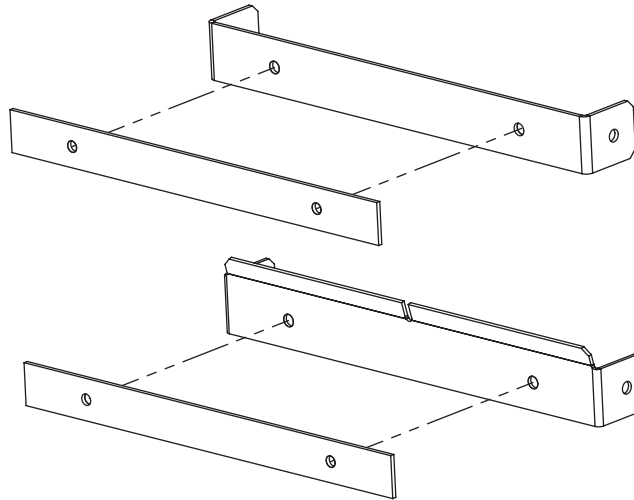

- 2 Position the bottom outer fixing bracket against the rear offside door using the measurements shown below (230mm from the side and 70mm from the bottom, measure to the hole centre). Once happy with the position mark the two hole centres and drill $\varnothing 8.5\text{mm}$.

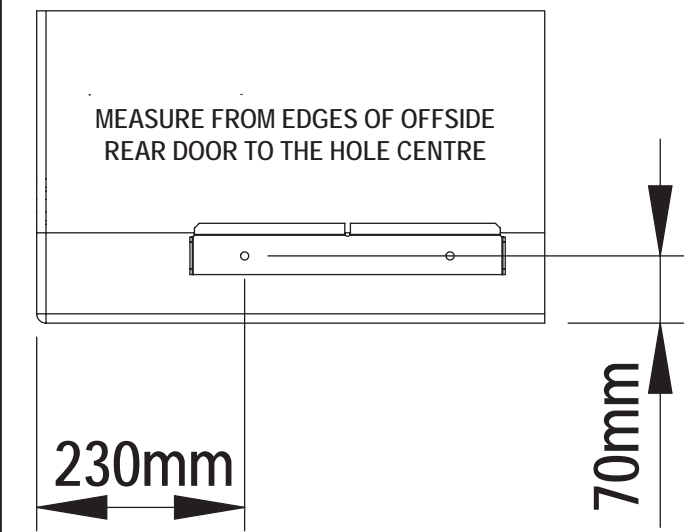

- 3 Secure the bottom outer fixing bracket to the rear door using M8x30 hex bolts (x2), M8 washers (x4), M8 shakeproofs (x2), M8 nuts (x2) and the bottom internal fixing plate (the smaller of the two).

OUTSIDE VIEW

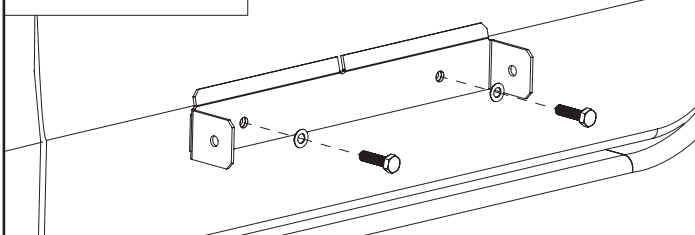

INSIDE VIEW

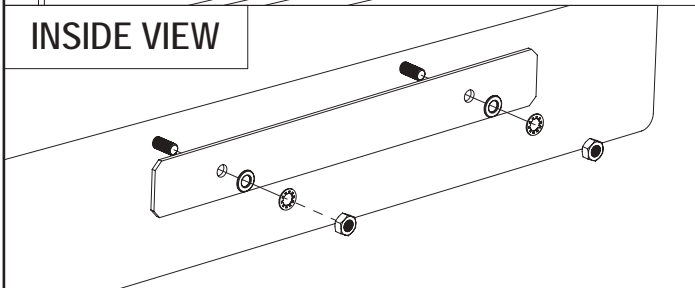

- 4 Loosely secure the spacer brackets to the bottom outer fixing bracket using M8x20 hex bolts (x2), M8 washers (x4), M8 shakeproofs (x2) and M8 nuts (x2). Do not use the extended spacer bracket at this point.

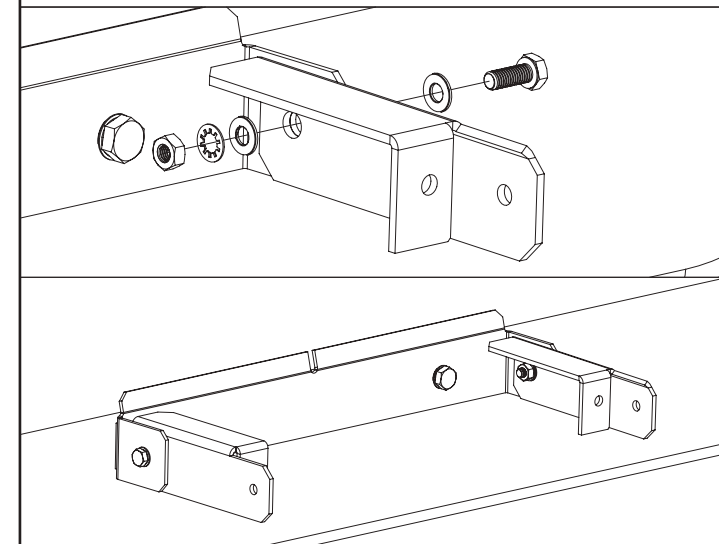

- 5** Loosely secure the remaining spacer brackets to the top outer fixing bracket using M8x20 hex bolts (x2), M8 washers (x4), M8 shakeproofs (x2) and M8 nuts (x2).

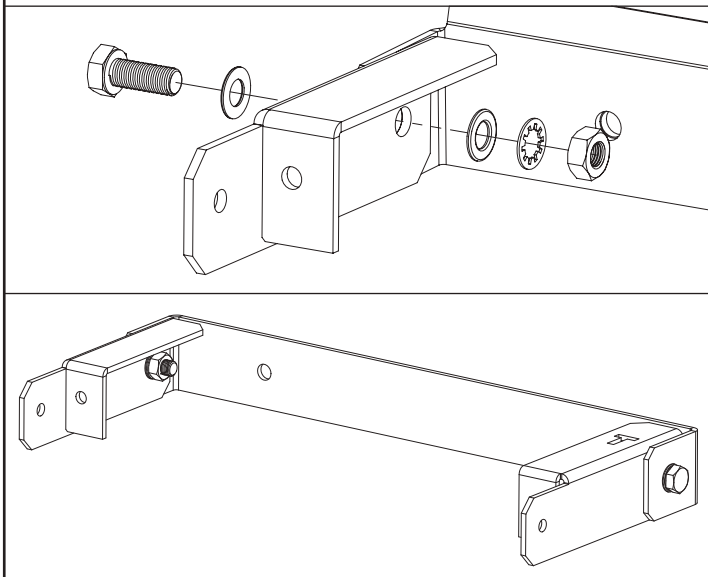

- 6** Secure the assembly from step 5 to the ladder using M6x16 hex bolts (x4), M6 washers (x8), M6 shakeproofs (x4) and M6 full nuts (x4). Use the top most fixing hole on the ladder (as shown).

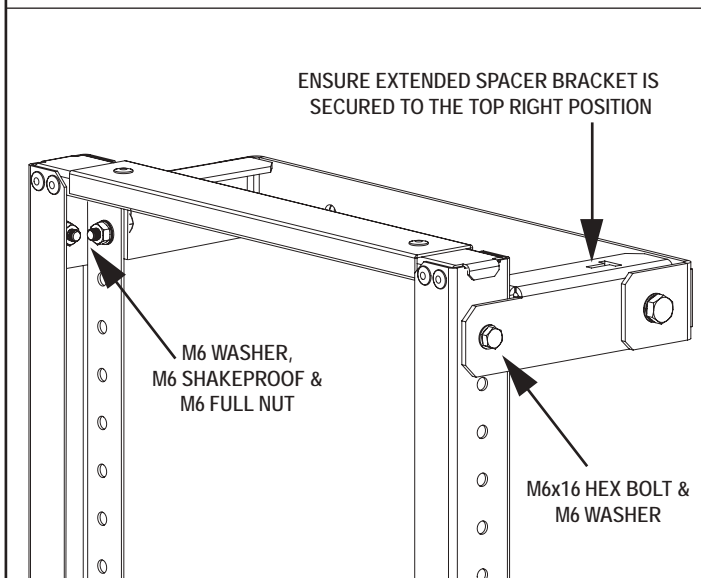

- 7** Loosely secure the ladder to the bottom outer fixing bracket assembly using M6x16 hex bolts (x4), M6 washers (x8), M6 shakeproofs (x4) and M6 full nuts (x4). Use the bottom most fixing hole on the ladder (as shown).

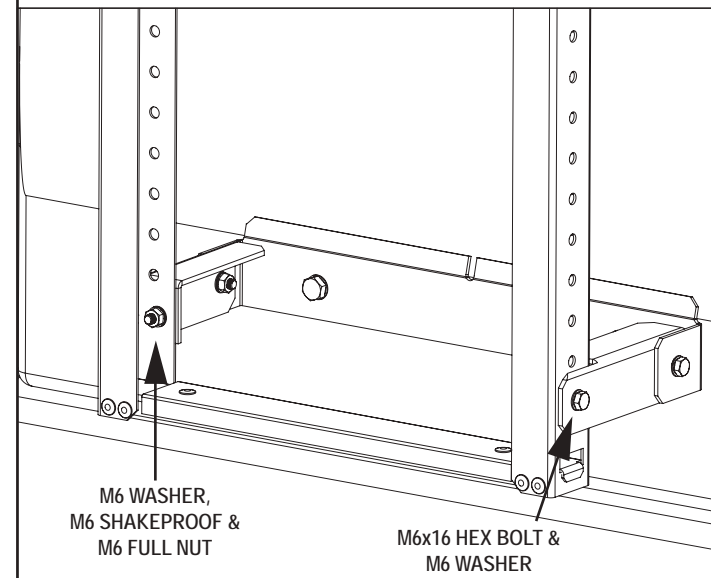

- 8** Push the top outer fixing bracket flush against the rear door, once happy with the position of the ladder drill \varnothing 8.5mm holes through the rear door in the two positions shown below.

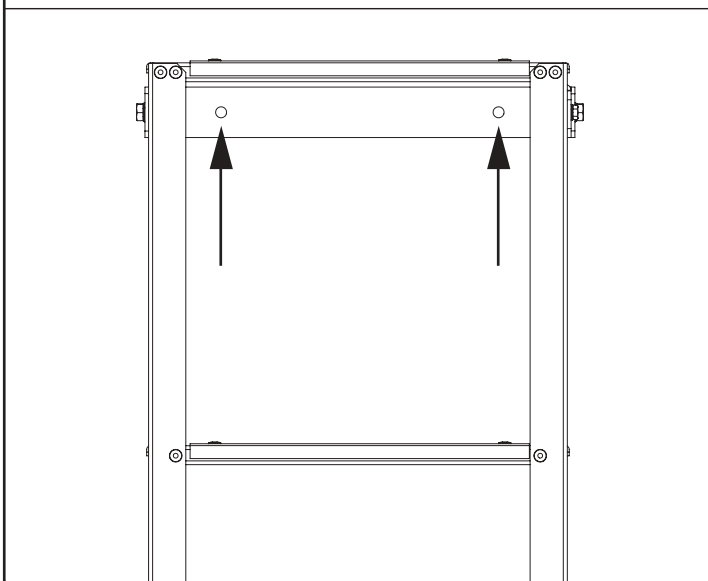

- 9** Secure the top outer fixing bracket to the rear door using M8x30 hex bolts (x2), M8 washers (x4), M8 shakeproofs (x2), M8 nuts (x2) and the top internal fixing plate (the larger of the two).

OUTSIDE VIEW

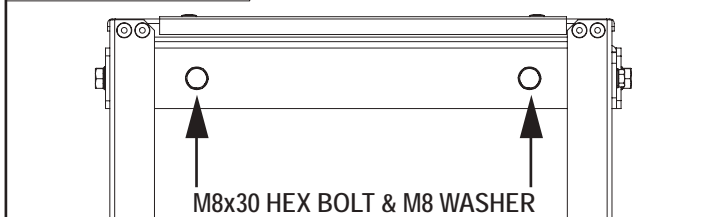

INSIDE VIEW

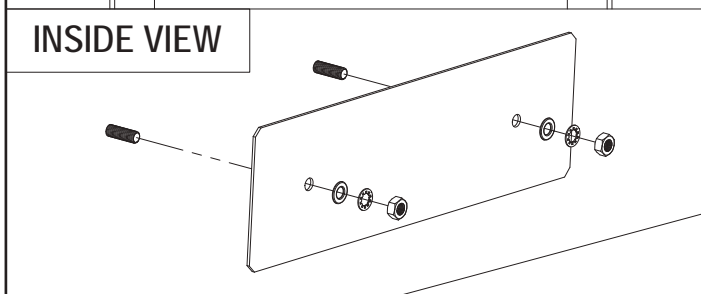

- 10** Once in position tighten all M6 fixings to 8Nm and all M8 fixings to 12Nm.



**TIGHTEN
TO
8/12Nm**

NOTES:
Periodically check all fixings.
Retain these instructions for future reference.

- 5** Loosely secure the remaining spacer brackets to the top outer fixing bracket using M8x20 hex bolts (x2), M8 washers (x4), M8 shakeproofs (x2) and M8 nuts (x2).

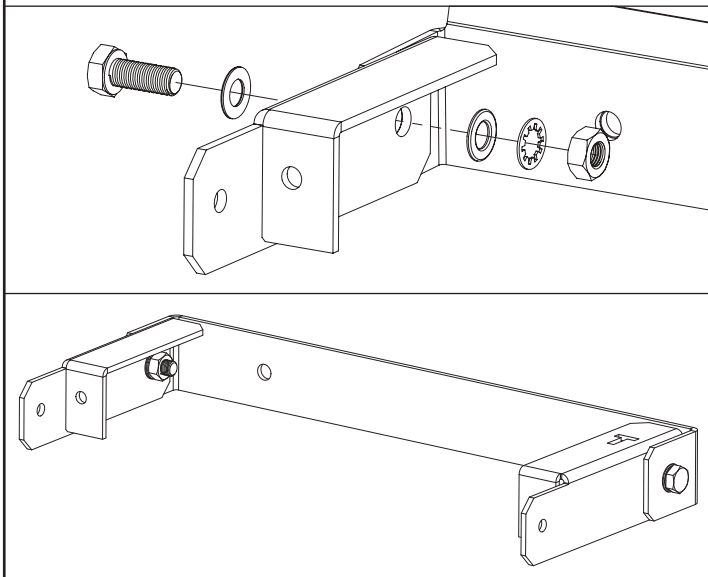

- 6** Secure the assembly from step 5 to the ladder using M6x16 hex bolts (x4), M6 washers (x8), M6 shakeproofs (x4) and M6 full nuts (x4). Use the top most fixing hole on the ladder (as shown).

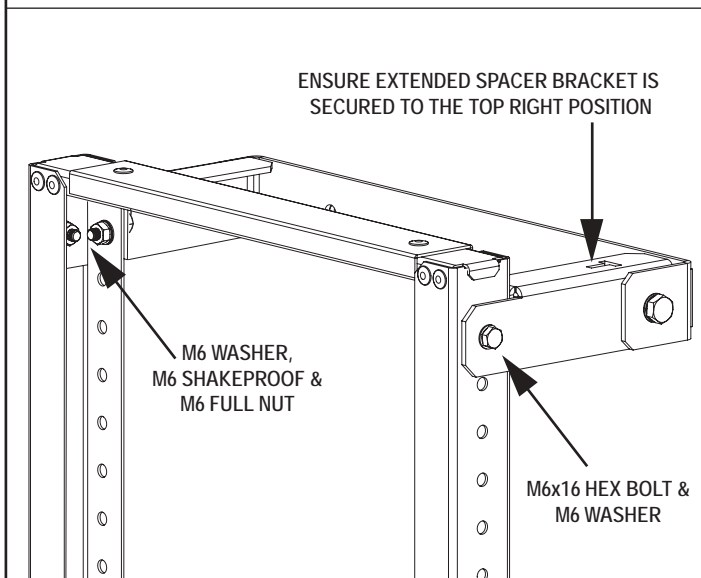

- 7** Loosely secure the ladder to the bottom outer fixing bracket assembly using M6x16 hex bolts (x4), M6 washers (x8), M6 shakeproofs (x4) and M6 full nuts (x4). Use the bottom most fixing hole on the ladder (as shown).

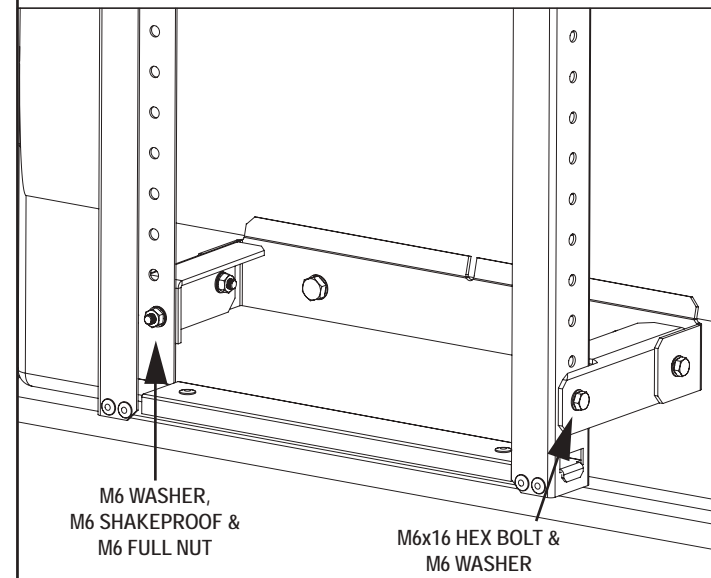

- 8** Push the top outer fixing bracket flush against the rear door, once happy with the position of the ladder drill \varnothing 8.5mm holes through the rear door in the two positions shown below.

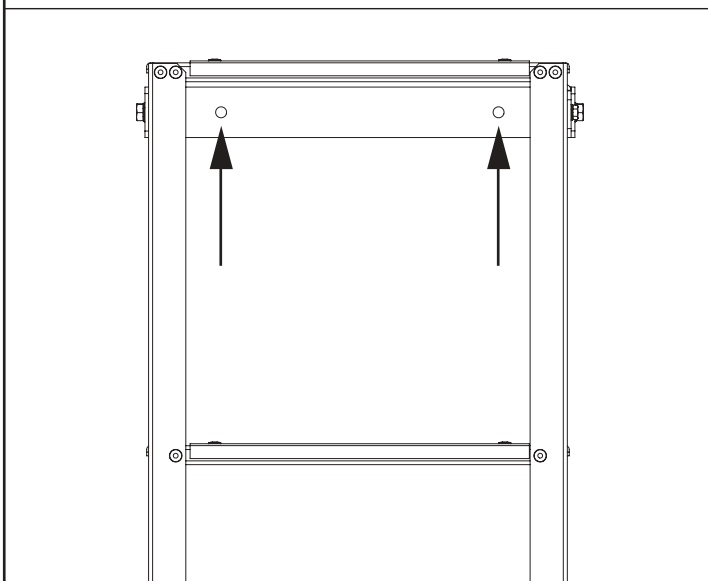

- 9** Secure the top outer fixing bracket to the rear door using M8x30 hex bolts (x2), M8 washers (x4), M8 shakeproofs (x2), M8 nuts (x2) and the top internal fixing plate (the larger of the two).

OUTSIDE VIEW

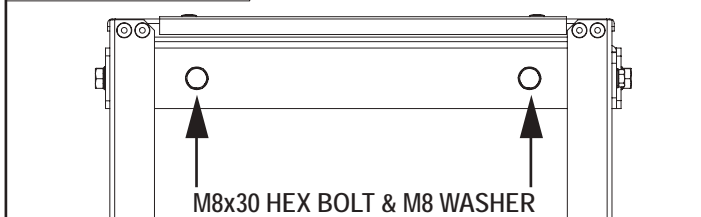

INSIDE VIEW

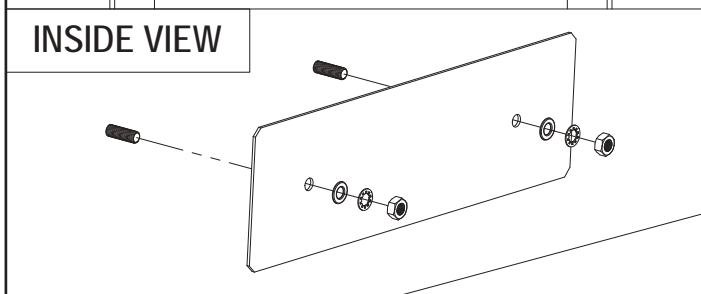

- 10** Once in position tighten all M6 fixings to 8Nm and all M8 fixings to 12Nm.



**TIGHTEN
TO
8/12Nm**

NOTES:
Periodically check all fixings.
Retain these instructions for future reference.