

#	PART NO.	QTY
1	AS3001	-
2	AS3002	3
3	AS3158	1
4	ME0022	1
5	ME0023	1
6	ME0024	2
7	ME0188	1
8	ME0189	1
9	MA6018	2
10	MA6027	4
11	MA6025	2
12	MA6077	2

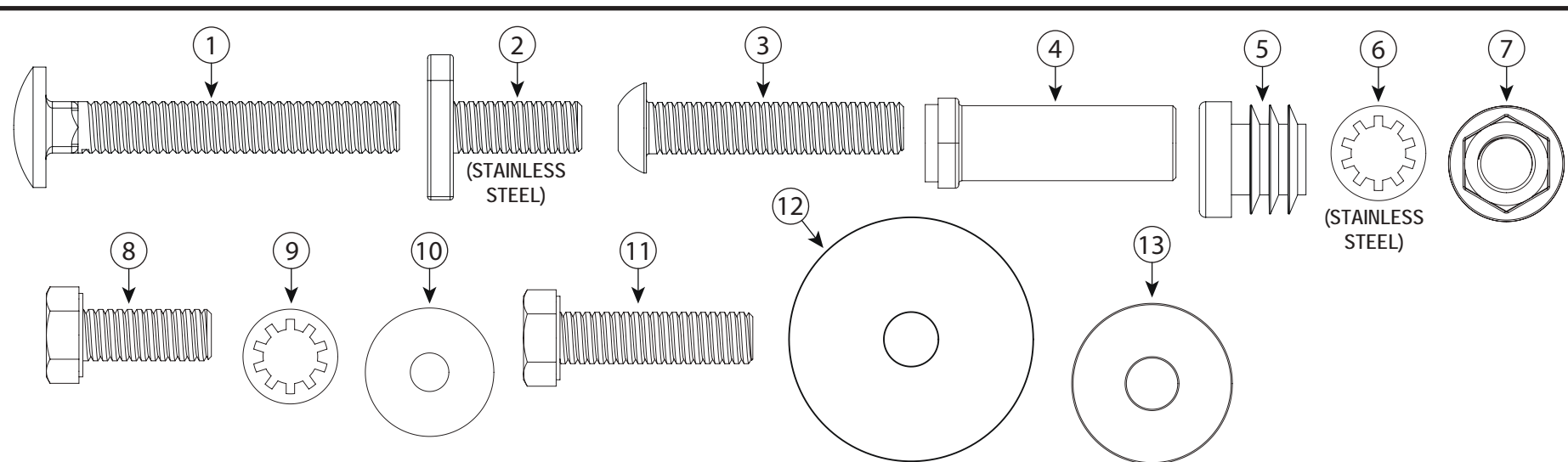

#	PART NO.	QTY
1	FX4027 (M8X55)	6
2	FX4139 (M8X20)	2
3	FX4001 (M8X40)	2
4	FX4007	2
5	MA6007	4
6	FX4036 (M8)	2
7	FX4011 (M8)	8
8	FX4018 (M8X20)	4
9	FX4019 (M8)	6
10	FX4014	6
11	FX4039 (M8X30)	4
12	FX4038 (M8X38)	2
13	FX4040 (M8X25)	6

VGUR-025

Vehicle:  
Ford Transit Connect: 2002 - 2014  
Wheel Base: SWB (L1)  
Roof Height: Low (H1)  
Rear Doors: Twin

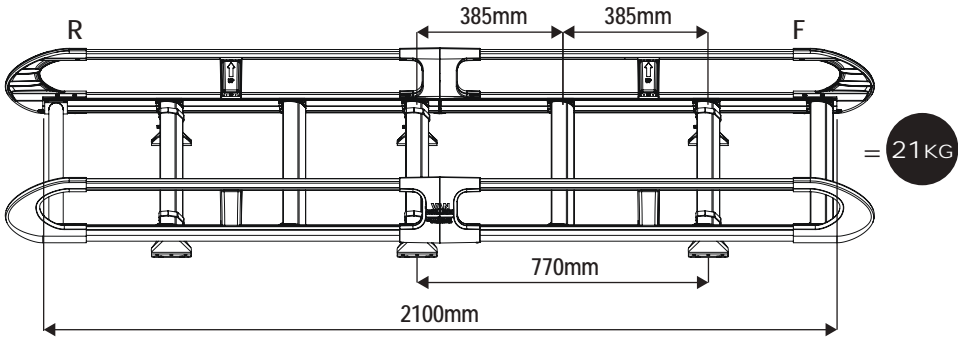
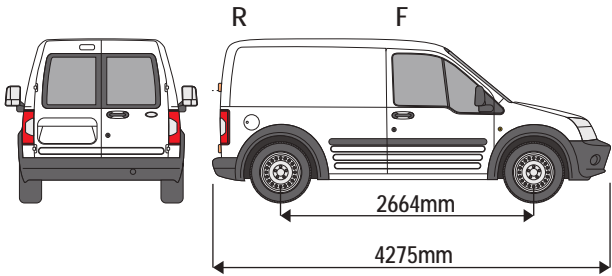

VGUR-026

Vehicle:  
Ford Transit Connect: 2002 - 2014  
Wheel Base: LWB (L2)  
Roof Height: High (H2)  
Rear Doors: Twin

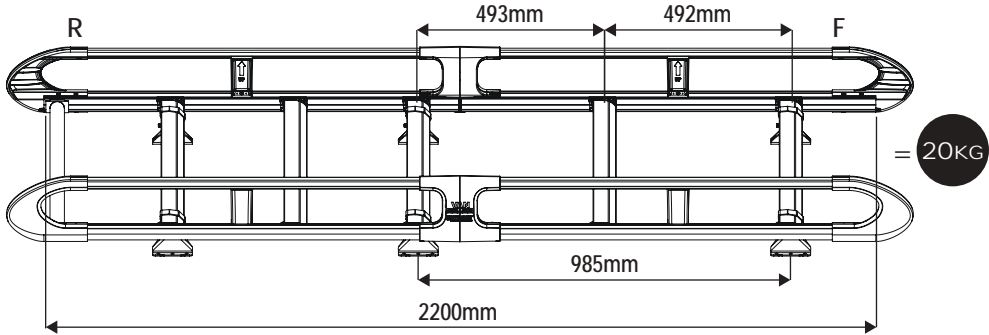
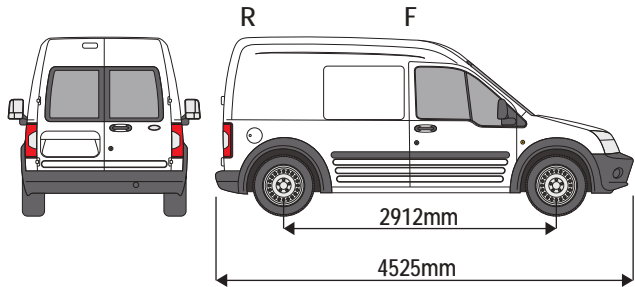

## TOOLS REQUIRED

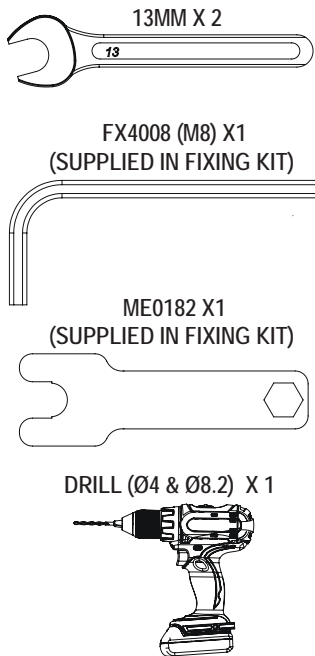

1

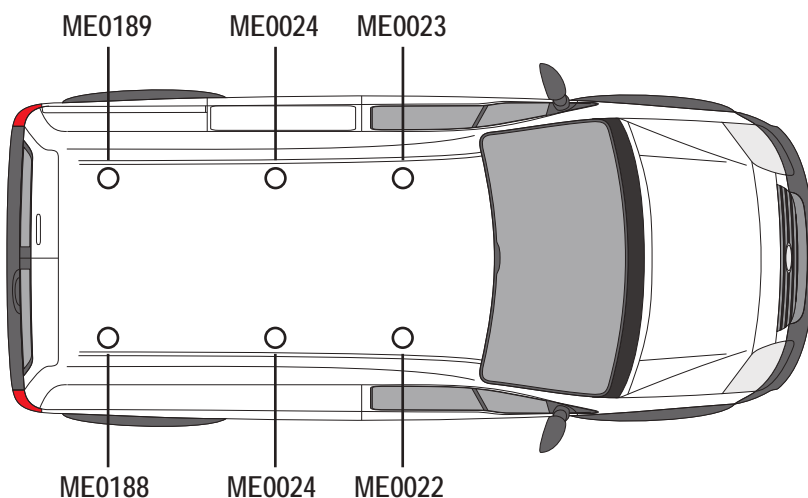

ME0022

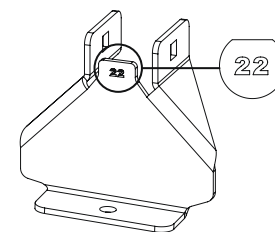

ME0023

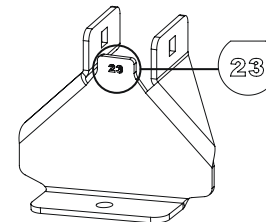

ME0024

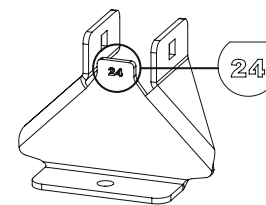

ME0188

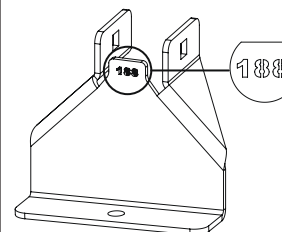

ME0189

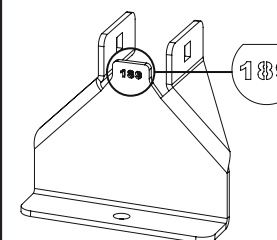

2

As there are no fixing points at the rear of the vehicle it's necessary to drill the roof to create 2X rear fixing points. Measure 155mm from the edge of the rear door opening and drill 2X fixing points (one either side) Ø8.2mm. It is recommended to drill a Ø4mm pilot hole first.

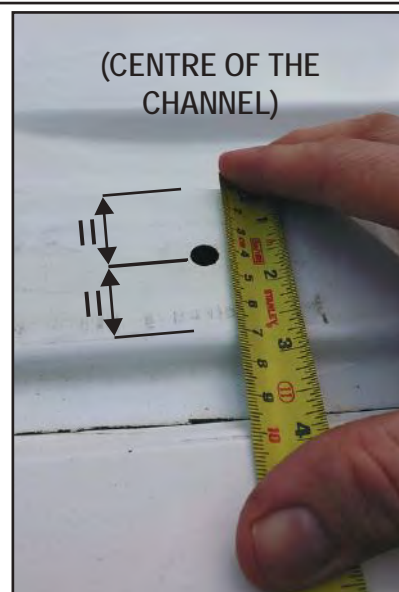
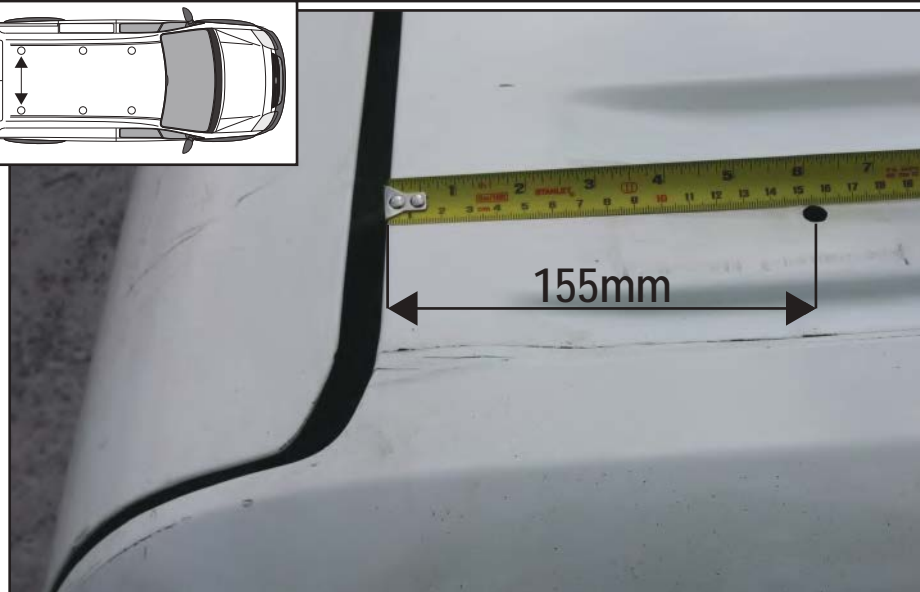
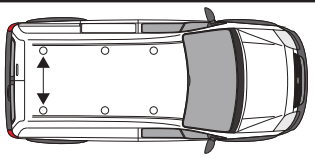

3

Stick thin rubber pads to the underside of the roof brackets. (MA6018 & MA6027).

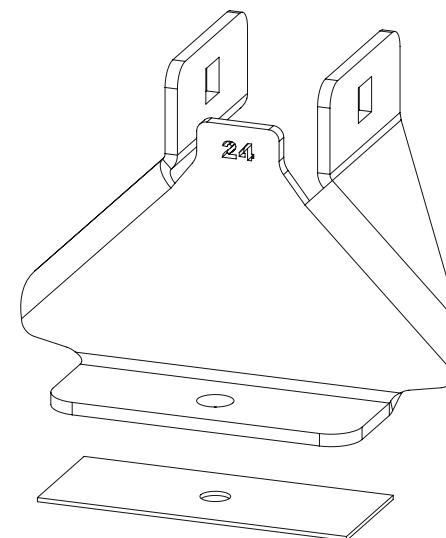

- 4** Remove the roof plugs to reveal the vehicles fixing points. Secure the front and middle roof brackets to the fixing points using M8x20 hex bolts, M8 shakeproof washers, M8x25 washers and rubber washers.

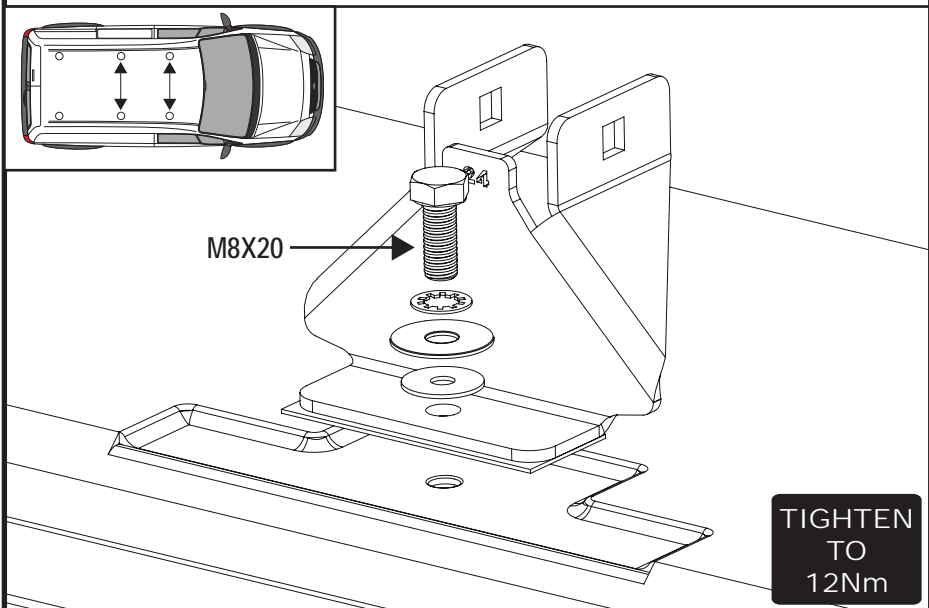

- 5** Secure the rear roof brackets by bolting down through the drilled fixing points using M8x30 hex bolts, M8 shakeproof washers, M8x25 washers and rubber washers. Secure under the roof using large rubber washers, M8x38 washers and M8 flange nuts.

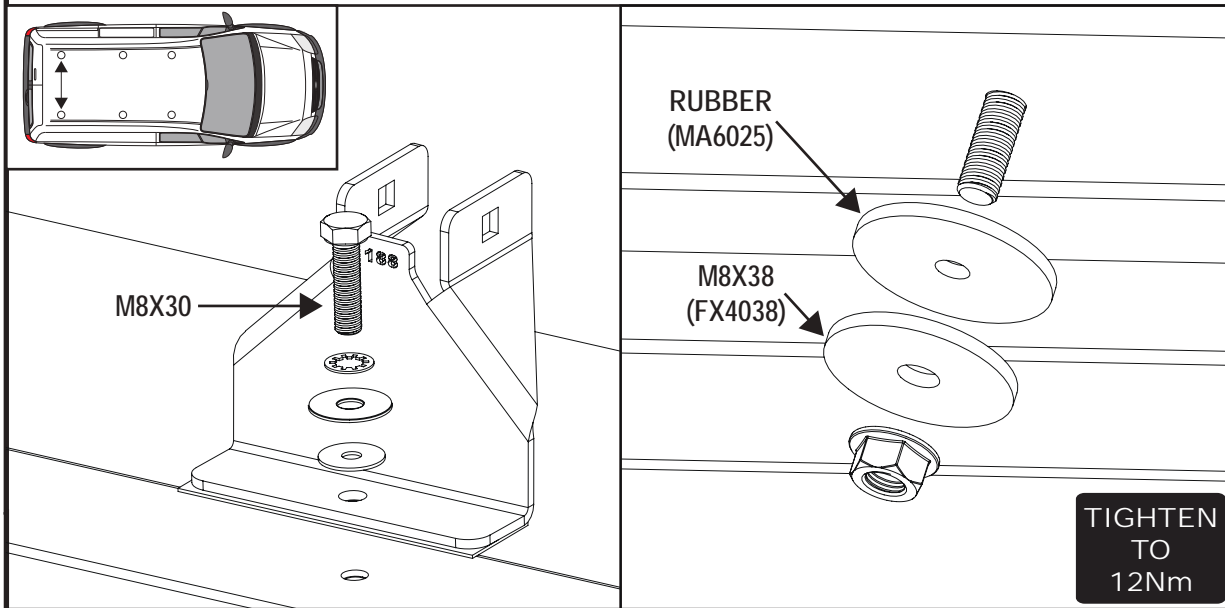

- 6** Loosely secure roof bars to the roof brackets using M8x55 coach bolts and M8 flange nuts.

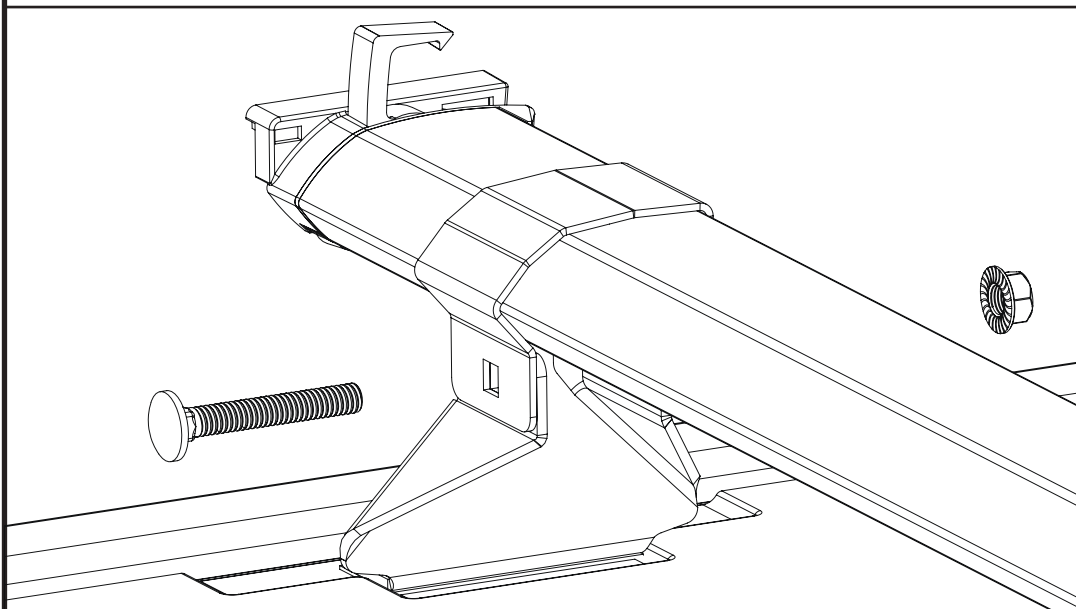

- 7** Place a flat object across the roof bars to ensure that they're level. If the roof bars sit level please skip to step 8. Due to the variance in some vehicles a spacer is supplied for the middle roof brackets. If the middle brackets are sitting too low please remove the middle brackets and re-secure using M8x30 hex bolts, spacer pads, M8 shakeproof washers, M8x25 washers and rubber washers.

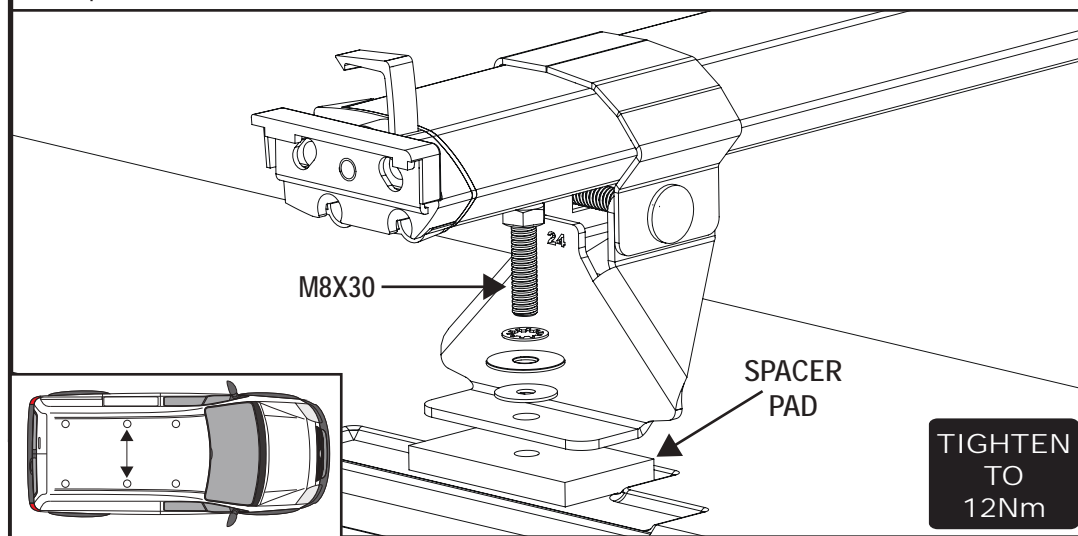

**8** Adjust the roof bars to ensure that they're evenly spaced on the vehicle.

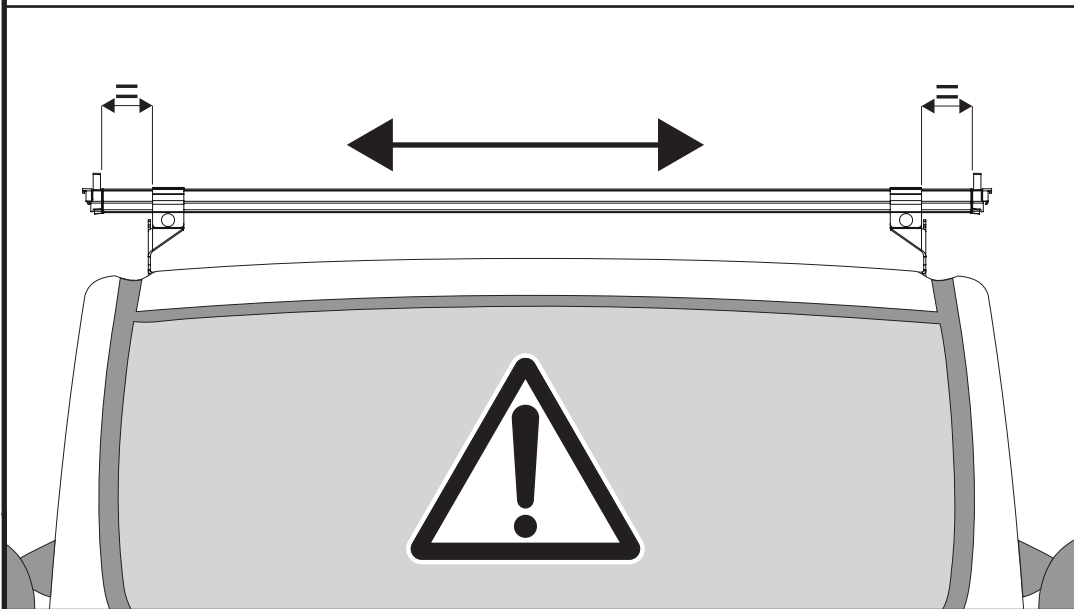

**9** Tighten the M8 flange nuts.

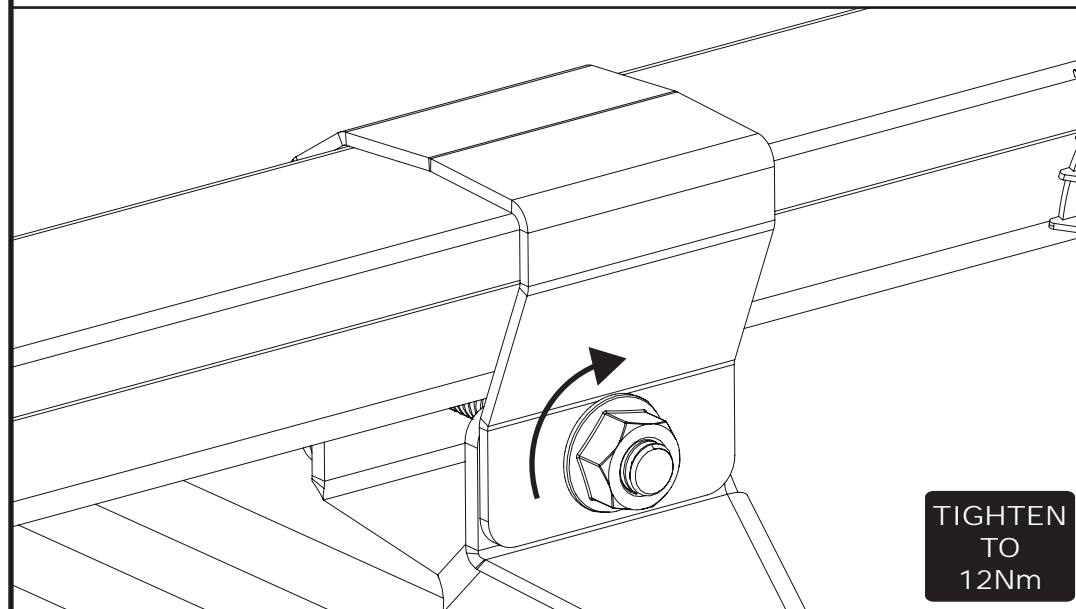

**10.1**

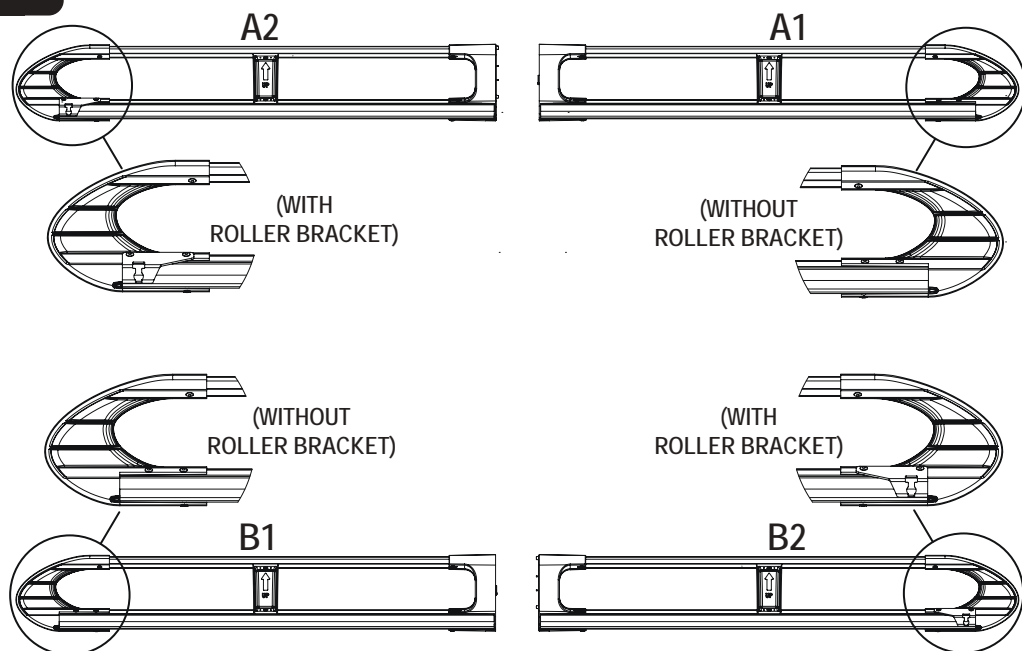

**10.2**

Assemble the side rails together using 1X M8x40 button bolt. Tighten using the supplied tool (FX4008). Repeat for the other side.

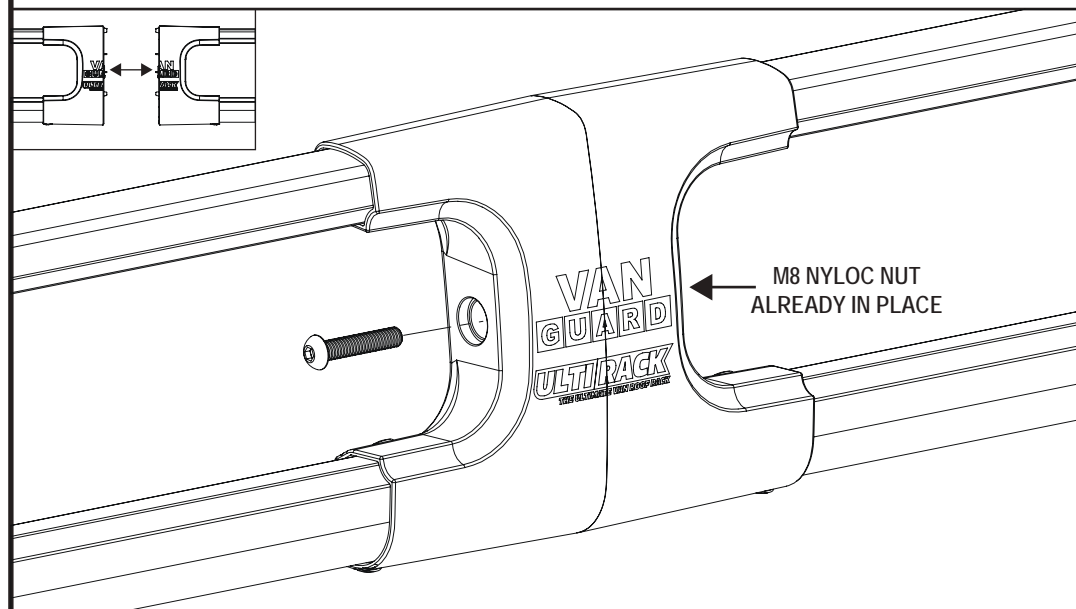

**11.1** Lift the side rails into position. Ensure that the side rails are connected to the roof bars correctly as per step 11.2.

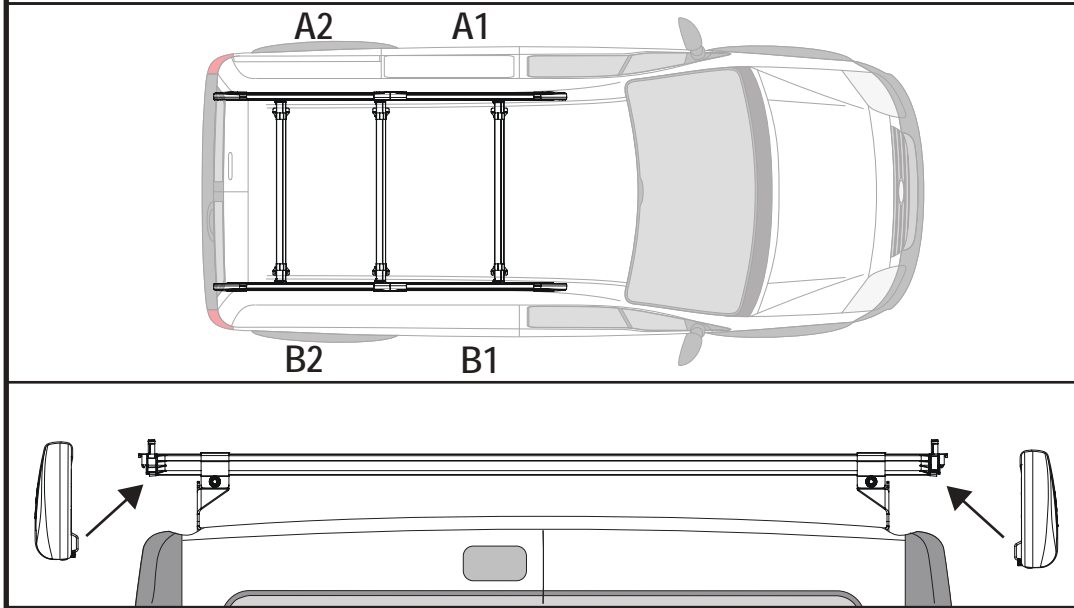

**11.2**

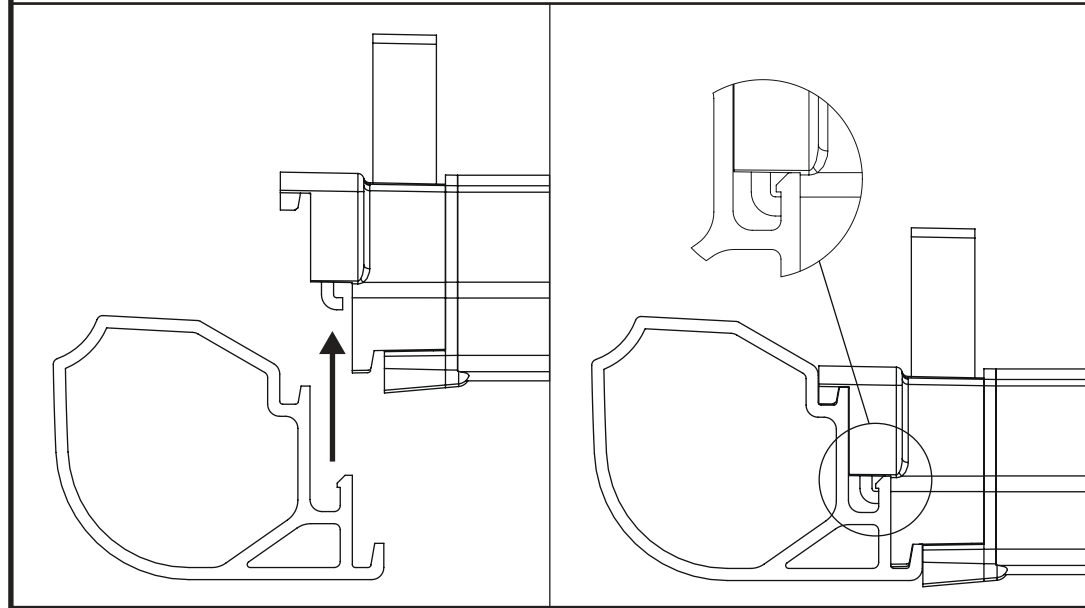

**12** Adjust the position of the side rails to suit the rear roller.

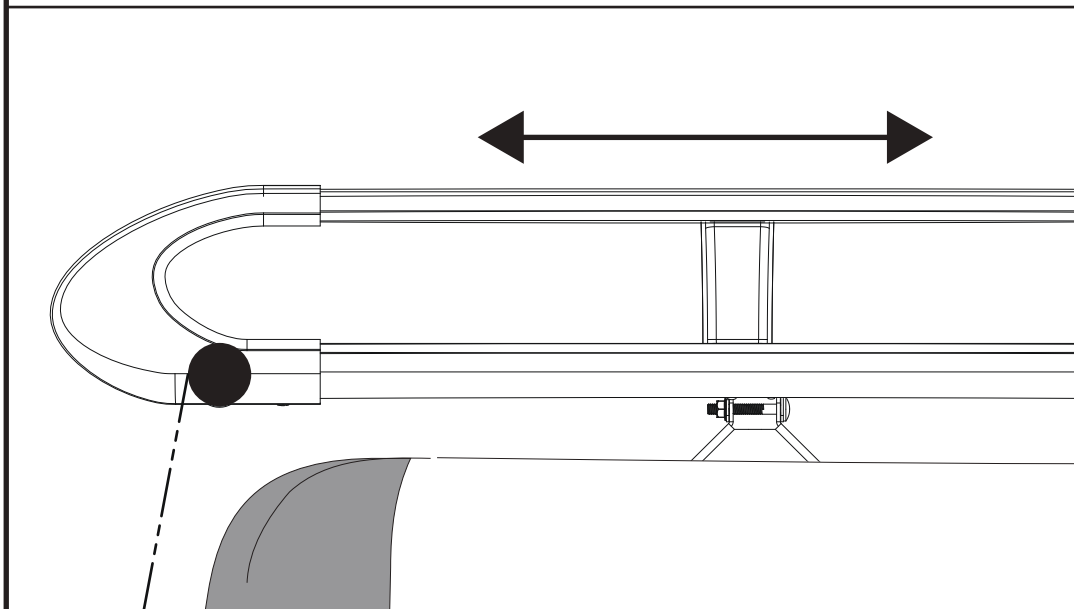

**13** Push on the lever to secure the 3X fixed roof bars into position.

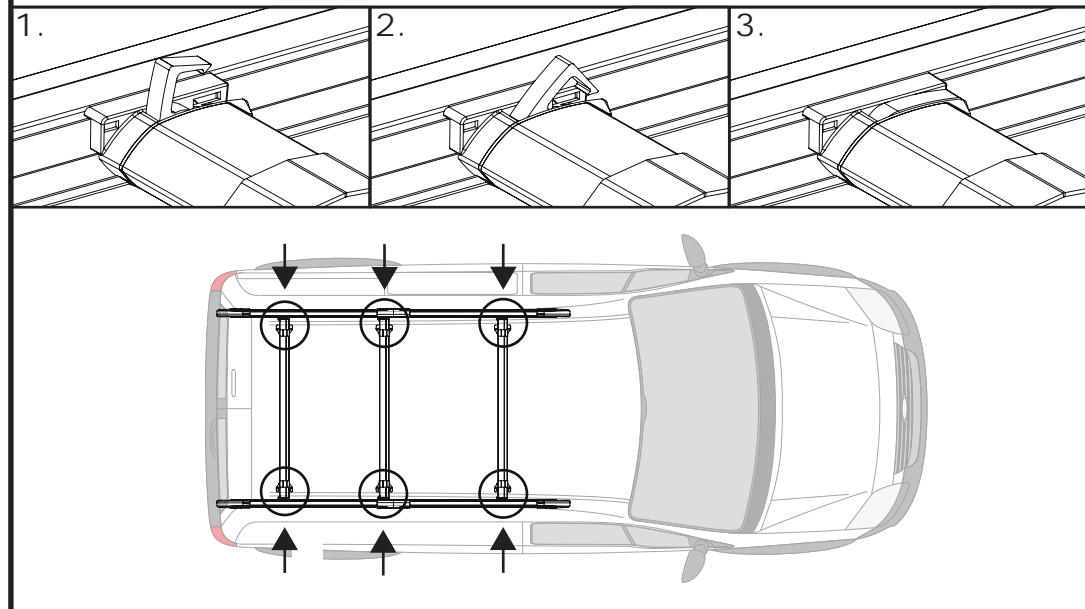



**14** Place the remaining roof bars into position. See page 2 for the recommended distances between the roof bars. Once in position push on the lever to secure in place.

\*IMAGE FOR ILLUSTRATION PURPOSES ONLY

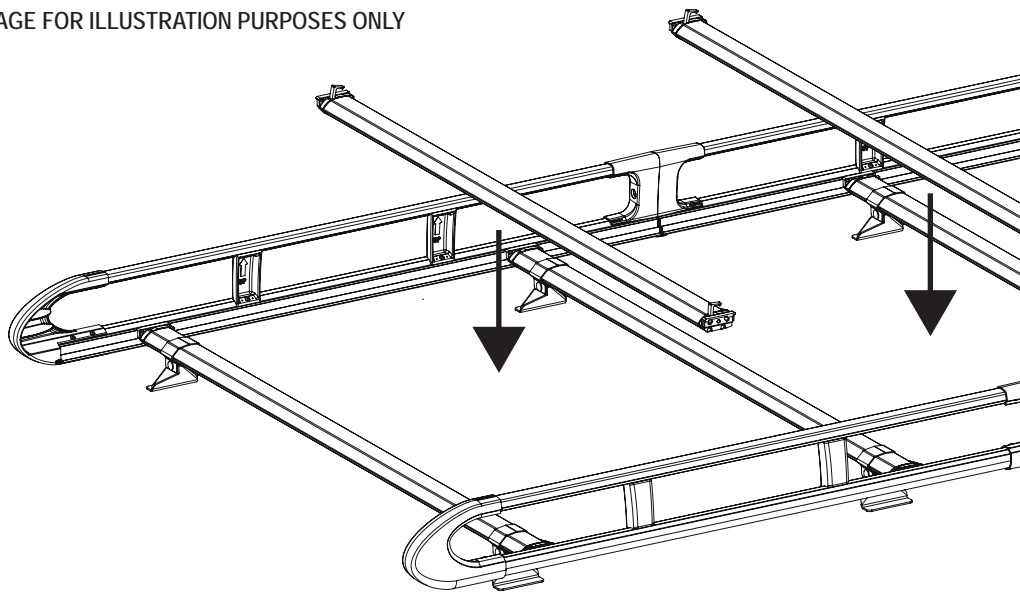

**15** Secure the roller spigot to the **left hand roller bracket only** using a M8 t bolt (FX4139) and a M8 shakeproof washer. Ensure that the shakeproof is on the inside of the roller bracket and that the spigot sits flush / straight. Tighten using the supplied tool.

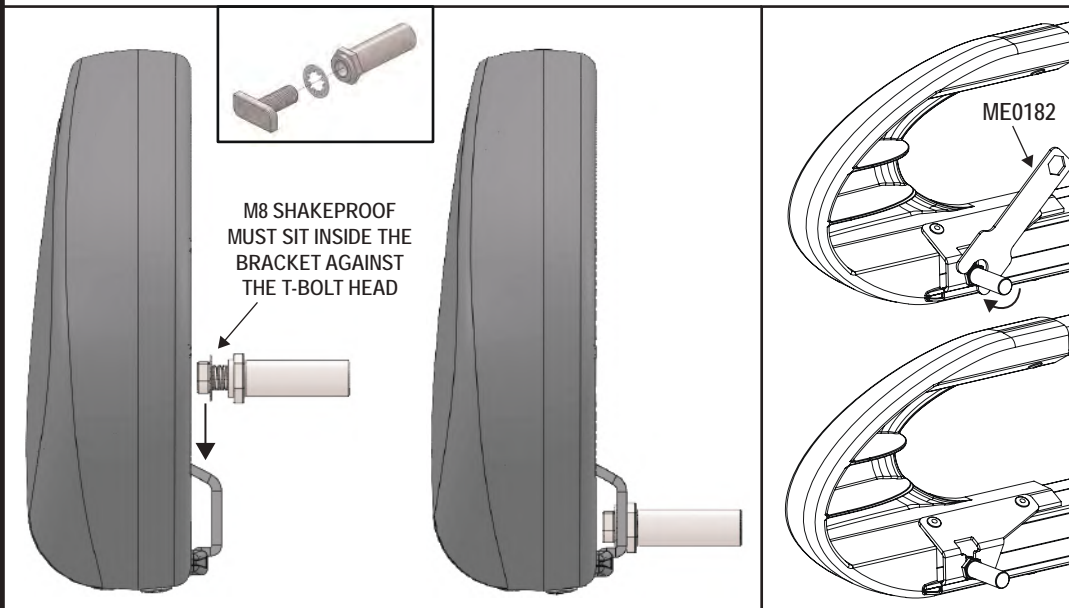

**16** Assemble the roller spigot, M8 t bolt (FX4139) and M8 shakeproof washer together. Place the assembly into the roller. Slide the roller onto the spigot fitted in step 15, drop the other end into position and then tighten using the supplied tool (ME0182).

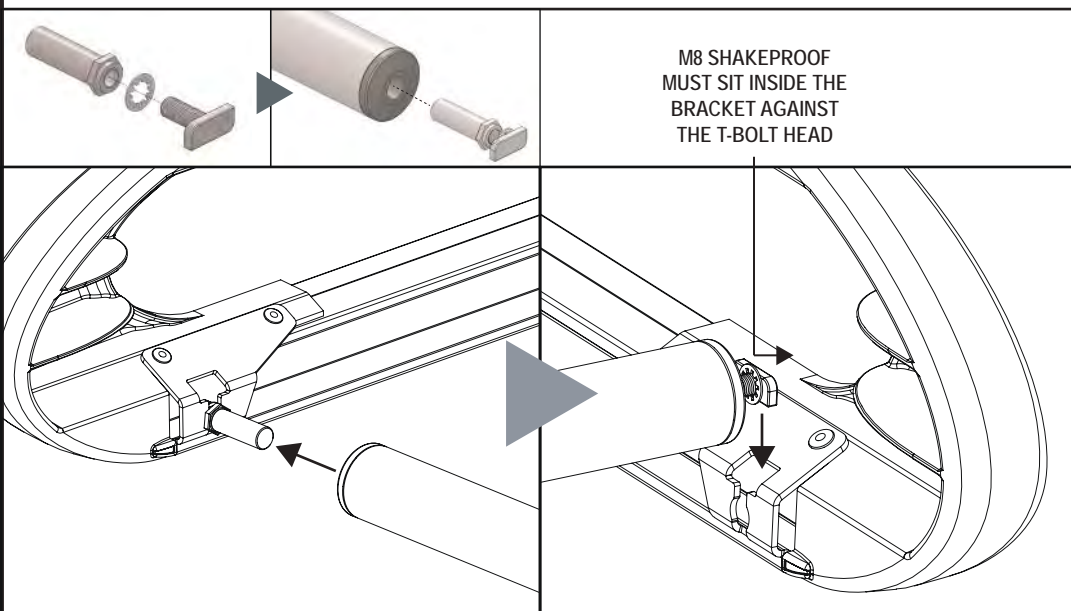

**17** Push the plastic bungs into position (X4).

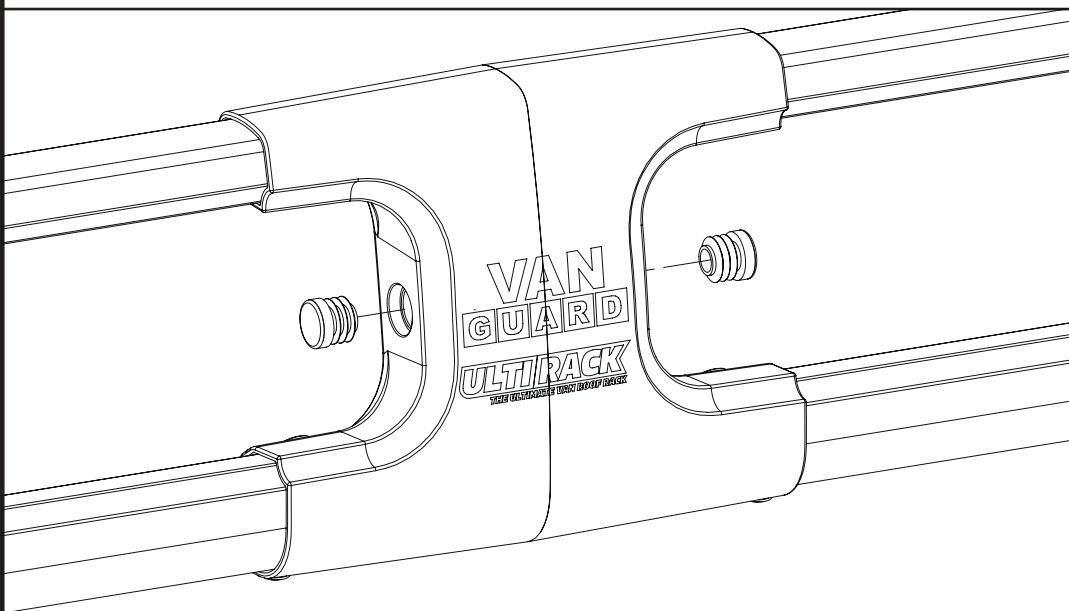

**18** Check bars are fully secured.

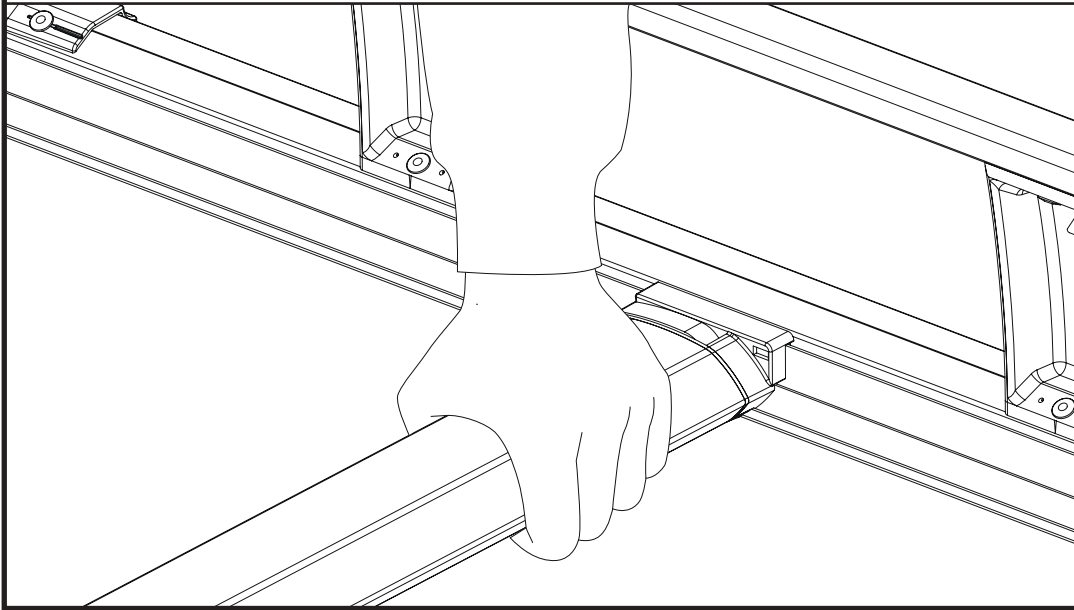

**19** Once the product has been fitted check fixings and parts to ensure they have been fully secured and tightened. Check fixings and parts at regular intervals. Any damaged or worn parts must be immediately removed from the vehicle and replaced.



**NOTES:**

Maximum load capacity: 100KG (Including rack weight - please refer to page 2.) (Maximum load must be in accordance with the vehicle manufacturer's load bearing capacity. Please refer to the vehicle's handbook.) Regularly check all fixings and parts.  
Retain these instructions for future reference. It is important that the end user receives this document.