

IN8240 **ULTI Rack**

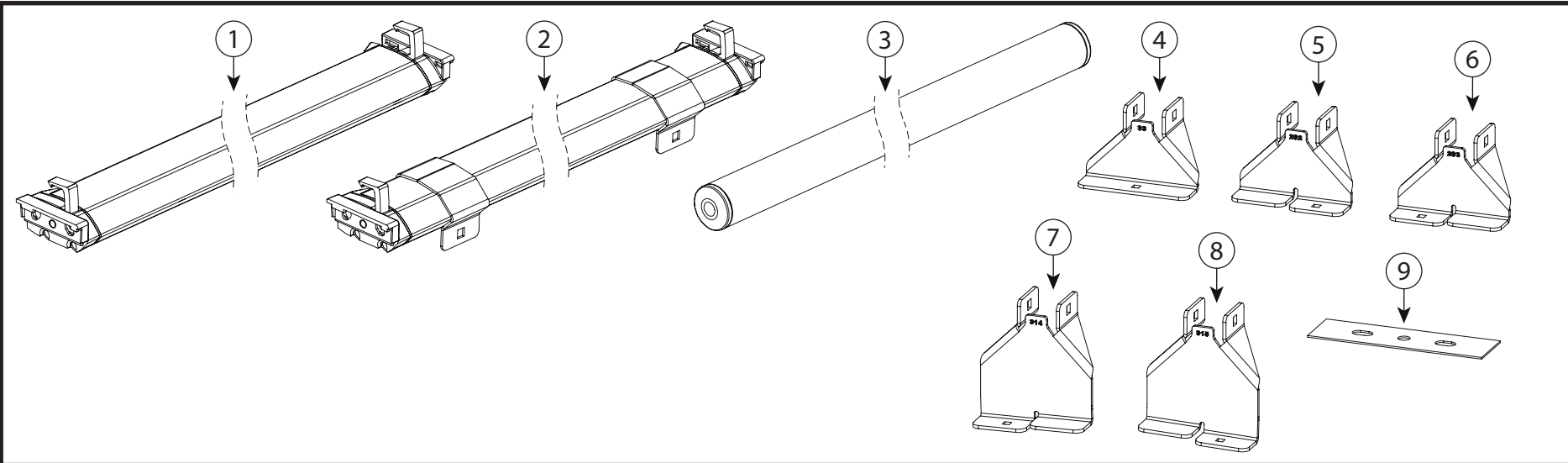

#	PART NO.	QTY
1	AS3005	3
2	AS3006	4
3	AS3160	1
4	ME0033	4
5	ME0292	1
6	ME0293	1
7	ME0314	1
8	ME0315	1
9	MA6091	8

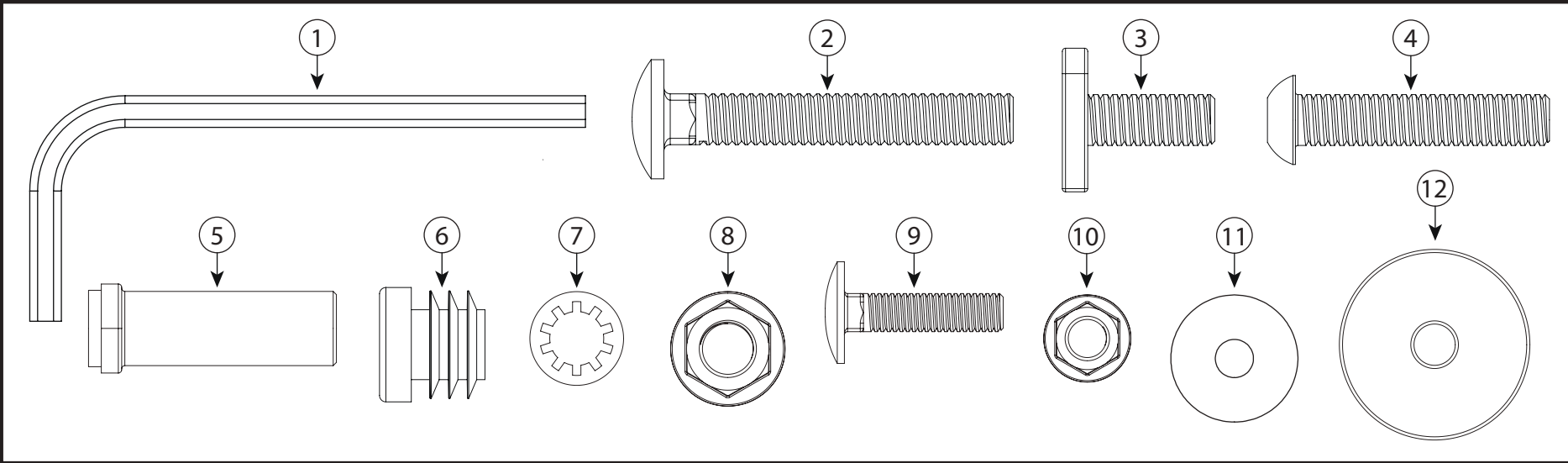

#	PART NO.	QTY
1	FX4008 (M8)	1
2	FX4027 (M8X55)	8
3	FX4139 (M8X20)	2
4	FX4001 (M8X40)	2
5	FX4007	2
6	MA6007	4
7	FX4036 (M8)	2
8	FX4011 (M8)	8
9	FX4022 (M6X25)	8
10	FX4016 (M6)	8
11	FX4014	8
12	FX4023 (M6)	8

VGUR-079

Vehicle:  
Volkswagen Crafter: 2017 on  
MAN TGE: 2017 on  
Wheel Base:  
Medium (L3)  
Standard (L3)  
Roof Height: Normal (H2)  
Rear Doors: Twin

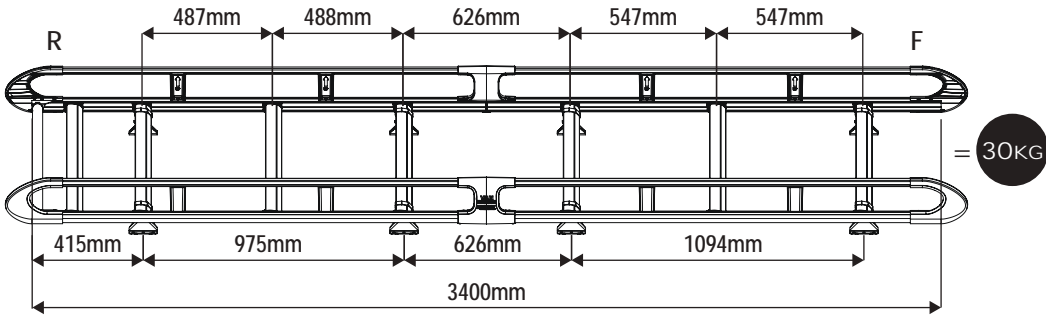
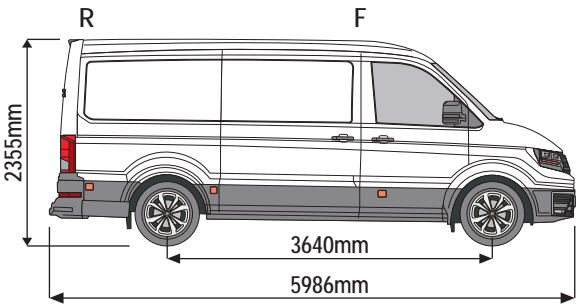

VGUR-080

Vehicle:  
Volkswagen Crafter: 2017 on  
MAN TGE: 2017 on  
Wheel Base:  
Medium (L3)  
Standard (L3)  
Roof Height: High (H3)  
Rear Doors: Twin

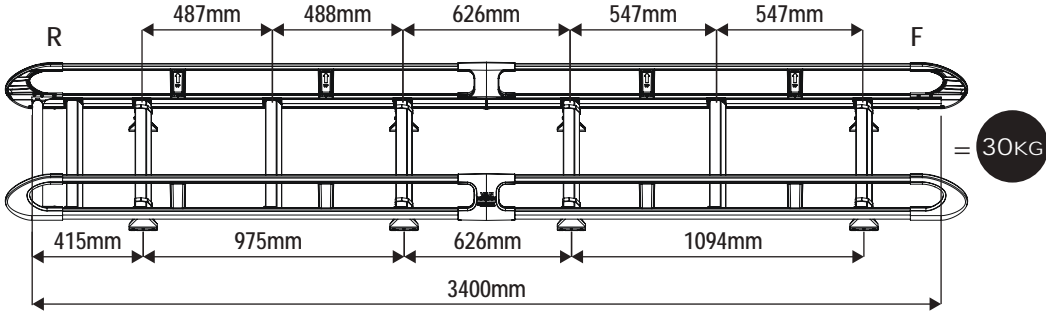
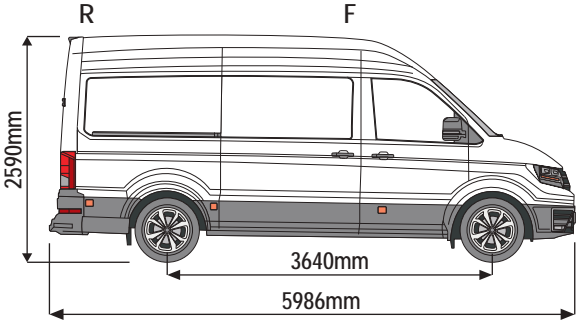

## TOOLS REQUIRED

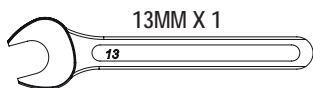
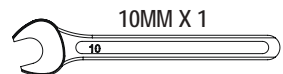

FX4008 (M8) X1  
(SUPPLIED IN FIXING KIT)

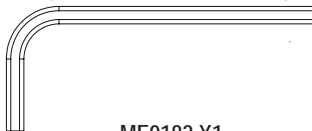

ME0182 X1  
(SUPPLIED IN FIXING KIT)

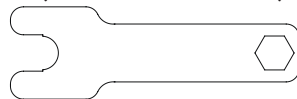

1

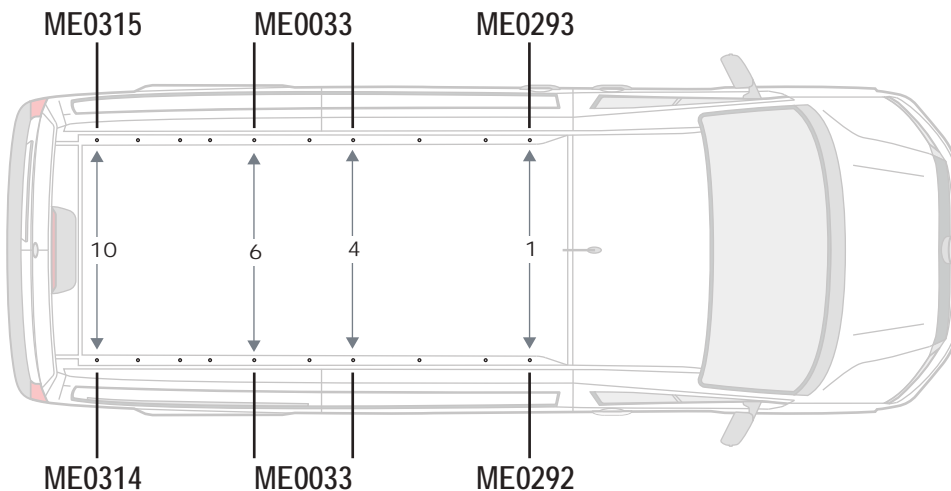

ME0033

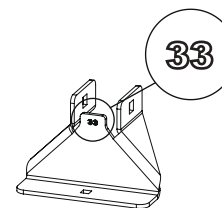

ME0292

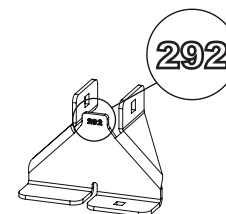

ME0293

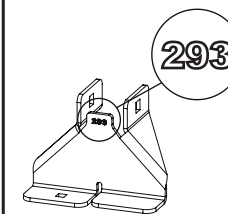

ME0314

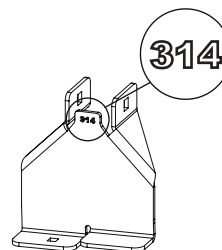

ME0315

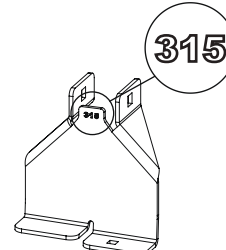

2

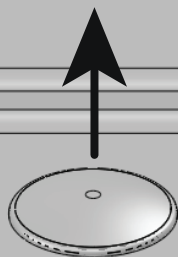

REMOVE ROOF PLUGS TO REVEAL  
THE VEHICLES FIXING POINTS  
ROOF PLUG MAY BE SEALED BY PAINT  
THIS SEAL WILL NEED TO BE BROKEN  
TO REMOVE THE ROOF PLUG



10

9

8

7

6

5

4

3

2

1

3

Stick rubber pads to the underside of all roof brackets.

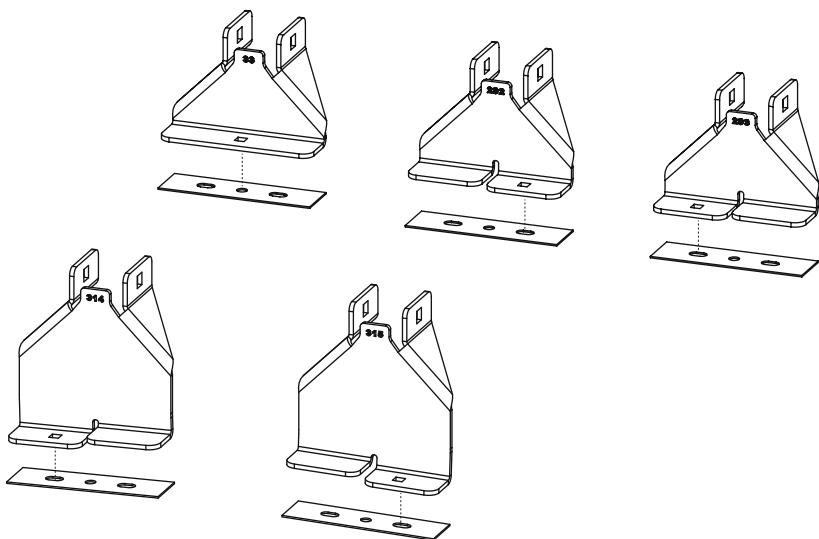

4

Place the roof brackets on the vehicles roof. See page 3 for the roof bracket positions.

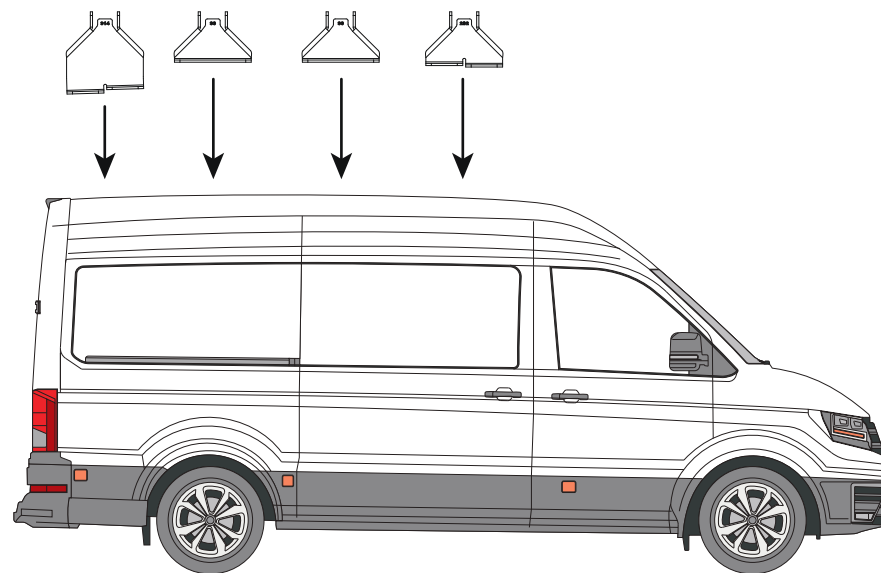

5

Secure the roof brackets to the fixing points by bolting through the roof using M6x25 coach bolts, secure under the roof using rubber washers, M6 washers and M6 flange nuts.

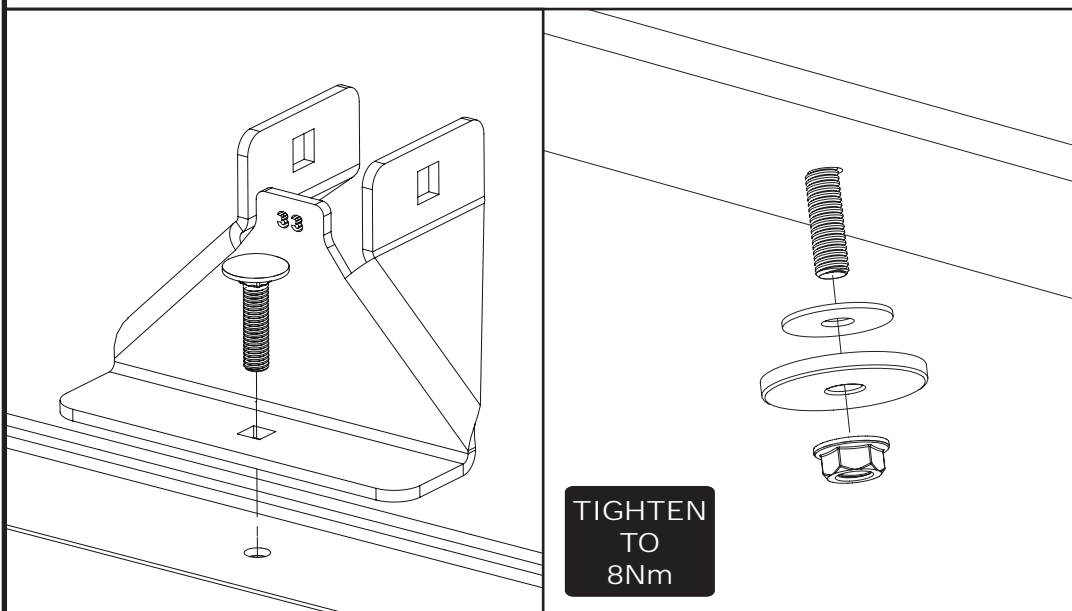

6

Loosely secure roof bars to the roof brackets using M8x55 coach bolts and M8 flange nuts.

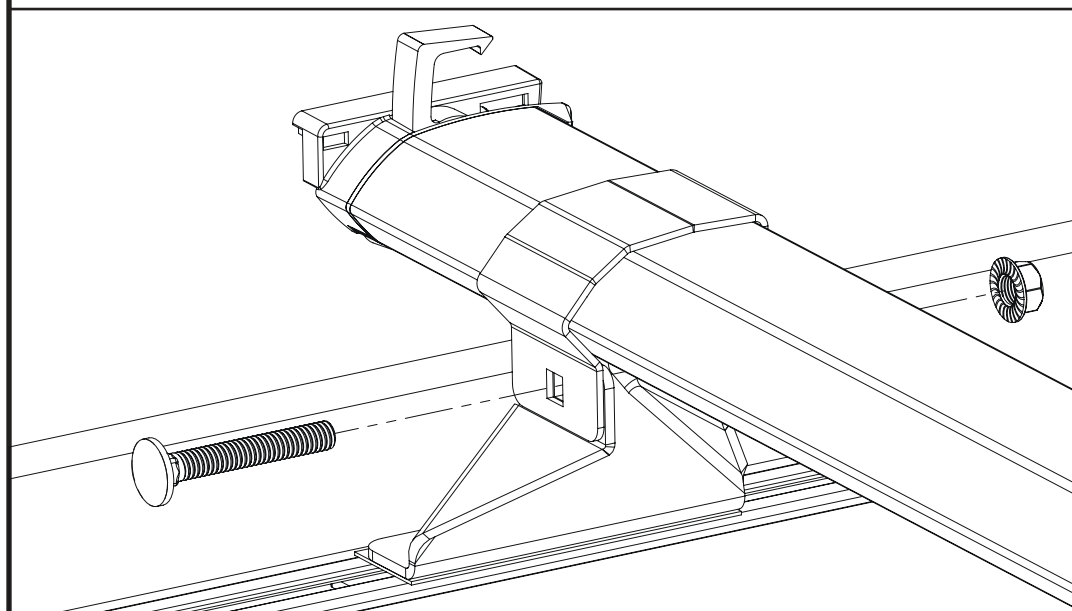

**7** Adjust the roof bars to ensure that they're evenly spaced on the vehicle.

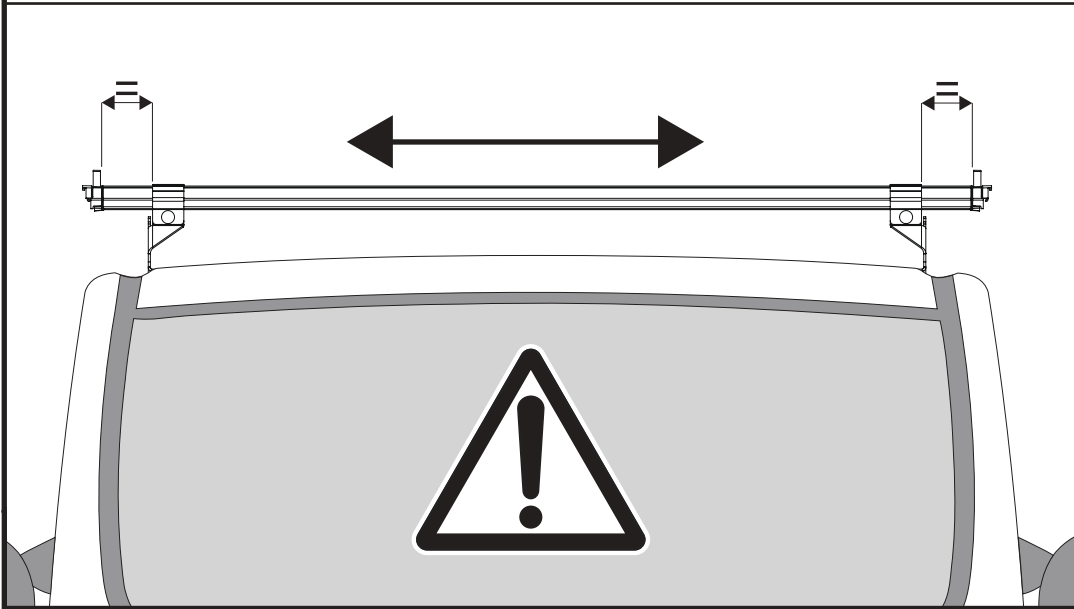

**8** Tighten the M8 flange nuts.

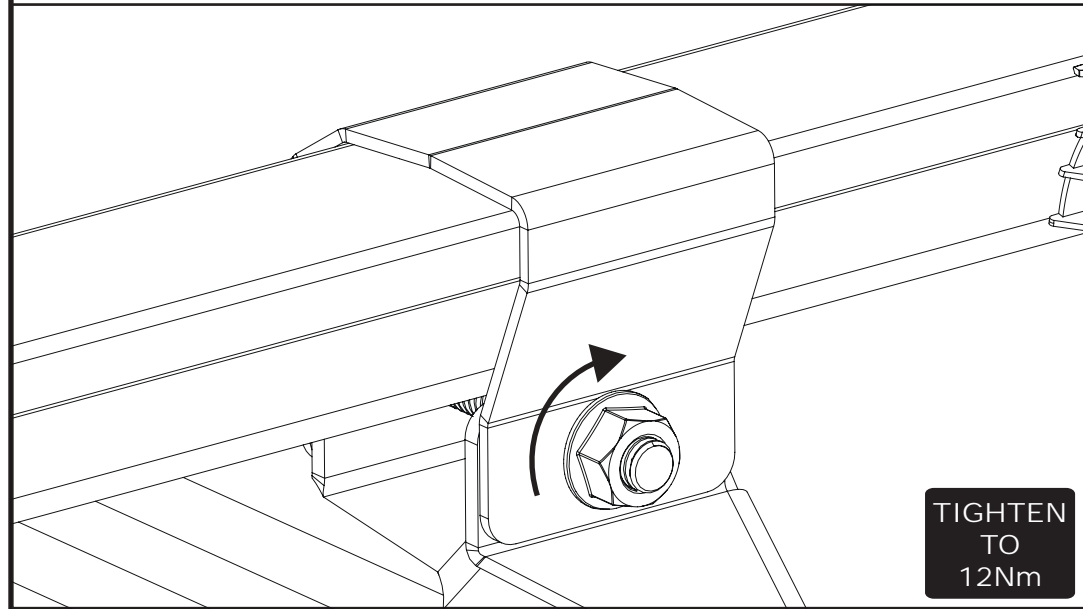

**9.1**

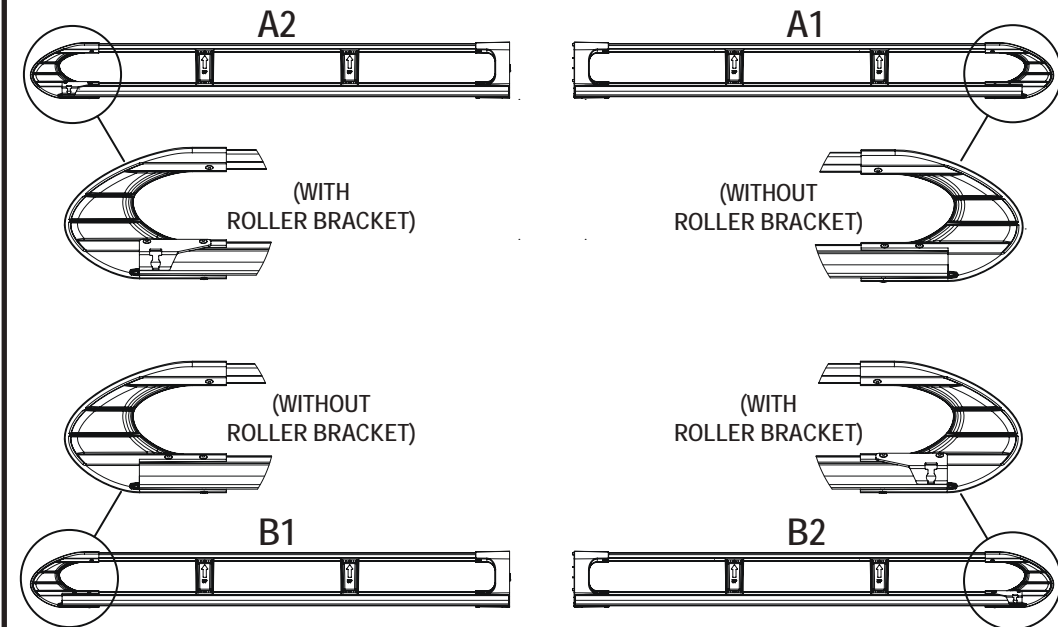

**9.2** Lift the rear side rail sections into position (A2 & B2). Ensure that the side rails are connected to the roof bars correctly as per step 9.3.

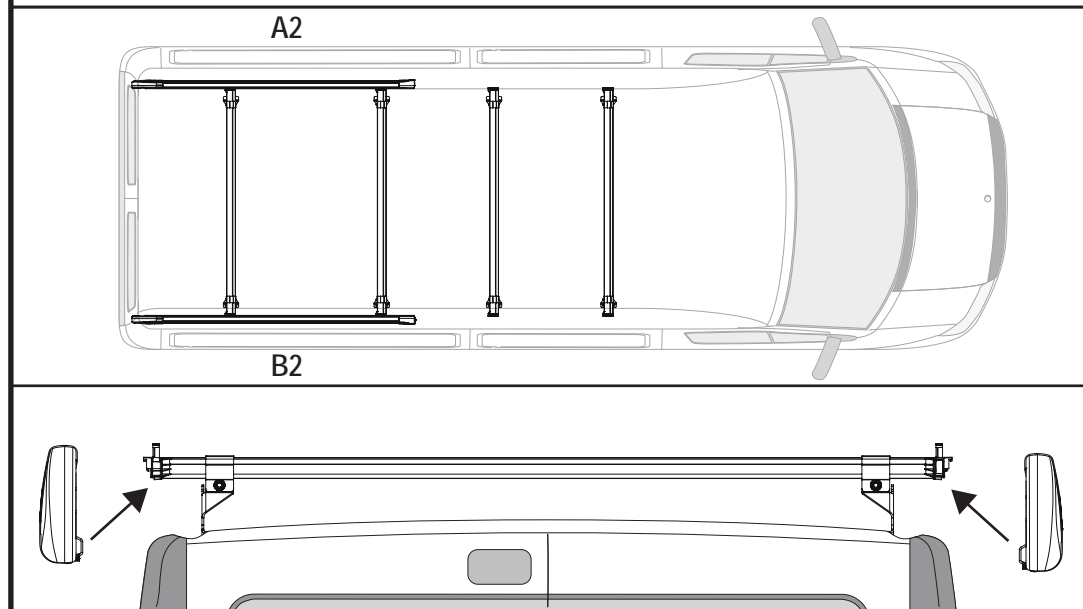

9.3

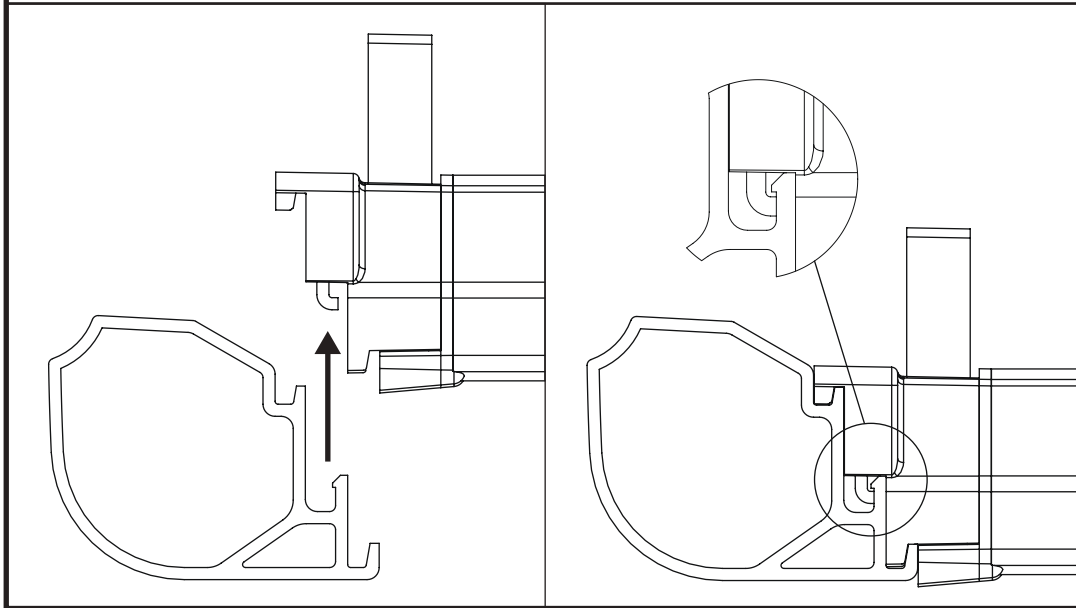

10

Adjust the position of the rear side rails to suit the rear roller.

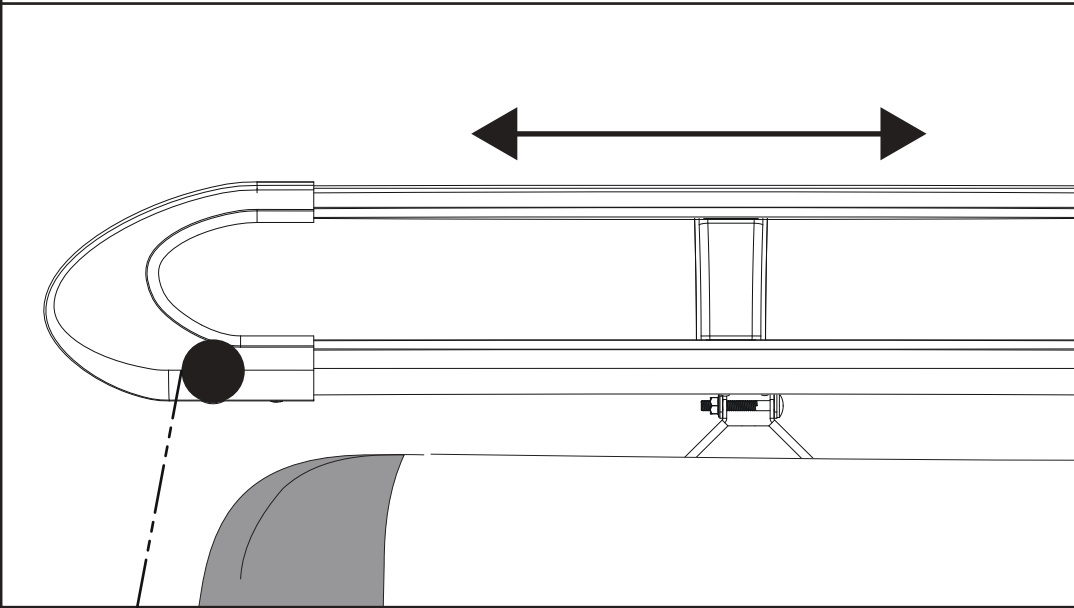

11

Push on the lever to secure the 2X rear fixed roof bars into position.

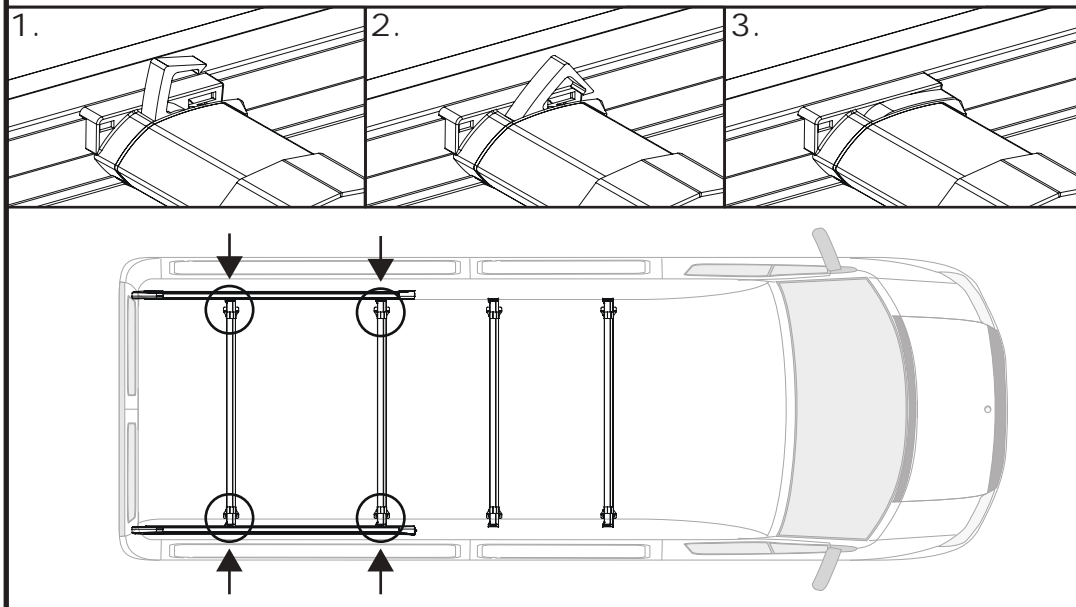

12

Lift the front side rail sections into position (A1 & B1). Ensure that the side rails are connected to the roof bars correctly as per step 9.3.

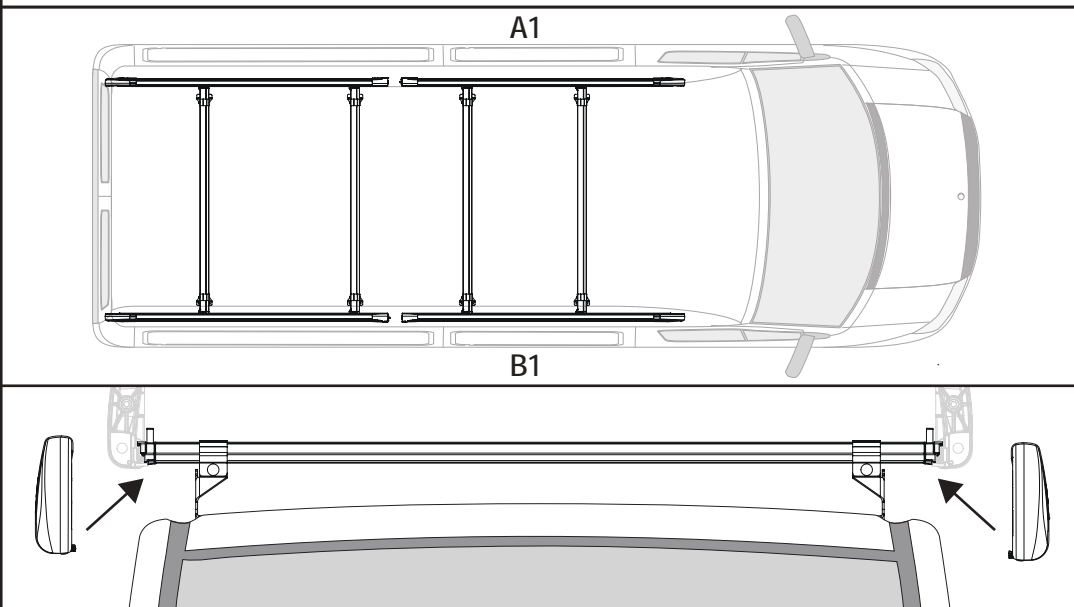

- 13** Slide the front side rail up to the rear side rail and secure together using 1X M8x40 button bolt. Tighten using the supplied tool (FX4008). Repeat for the other side.

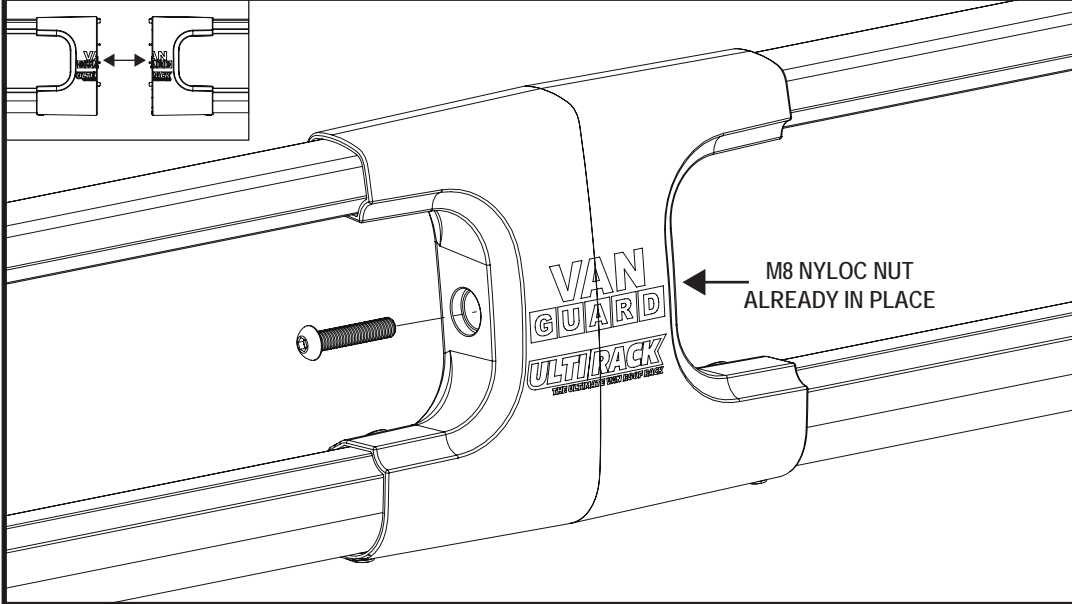

- 14** Push on the lever to secure the 2X front fixed roof bars into position.

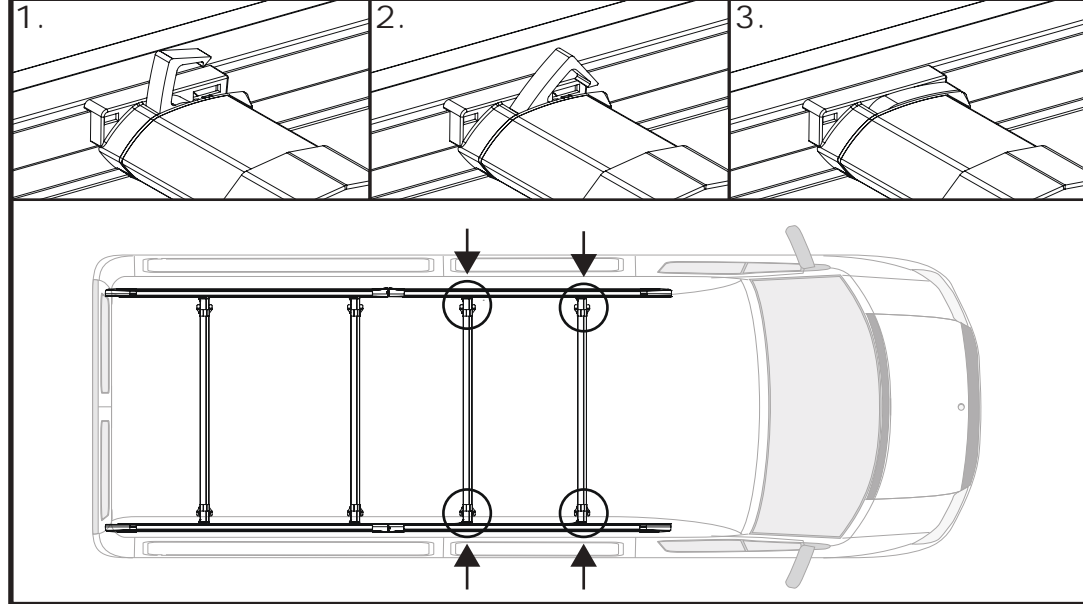

- 15** Place the remaining roof bars into position. See page 2 for the recommended distances between the roof bars. Once in position push on the lever to secure in place.

\*IMAGE FOR ILLUSTRATION PURPOSES ONLY

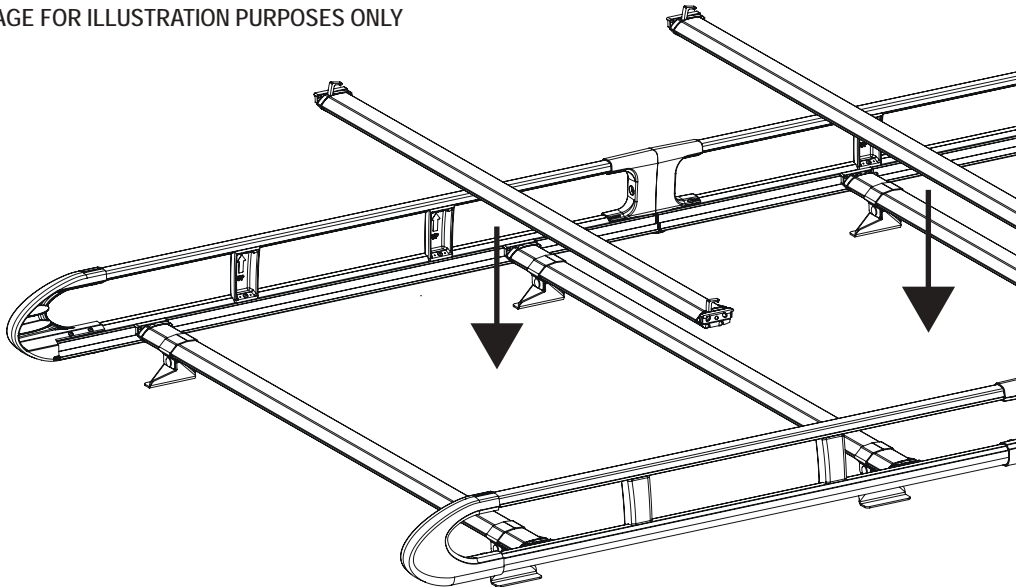

- 16** Secure the roller spigot to the **left hand roller bracket only** using a M8 t bolt (FX4139) and a M8 shakeproof washer. Ensure that the shakeproof is on the inside of the roller bracket and that the spigot sits flush / straight. Tighten using the supplied tool.

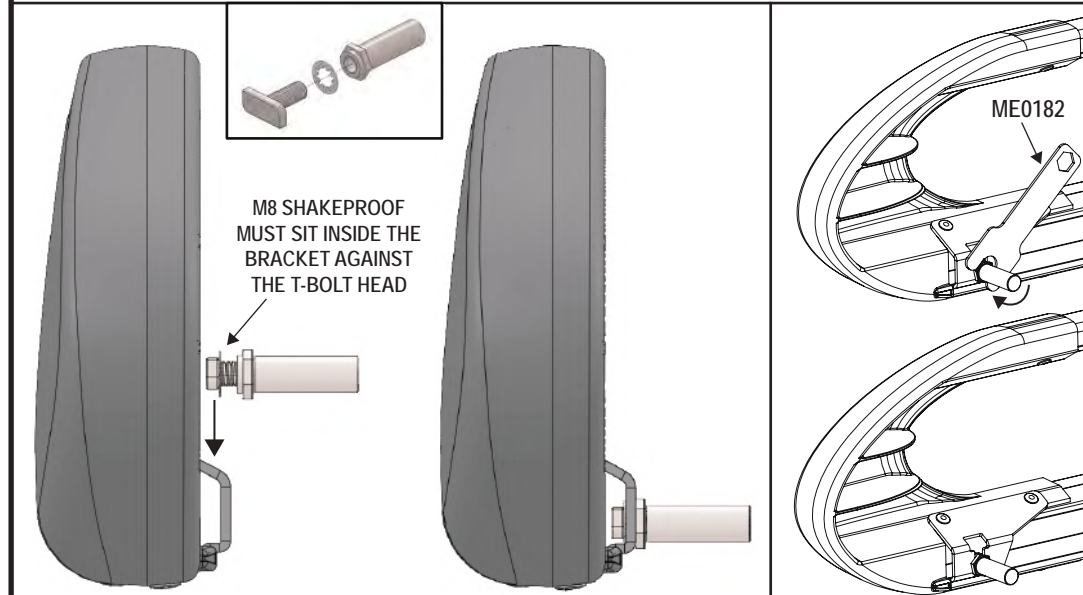



- 17** Assemble the roller spigot, M8 t bolt (FX4139) and M8 shakeproof washer together. Place the assembly into the roller. Slide the roller onto the spigot fitted in step 16, drop the other end into position and then tighten using the supplied tool (ME0182).

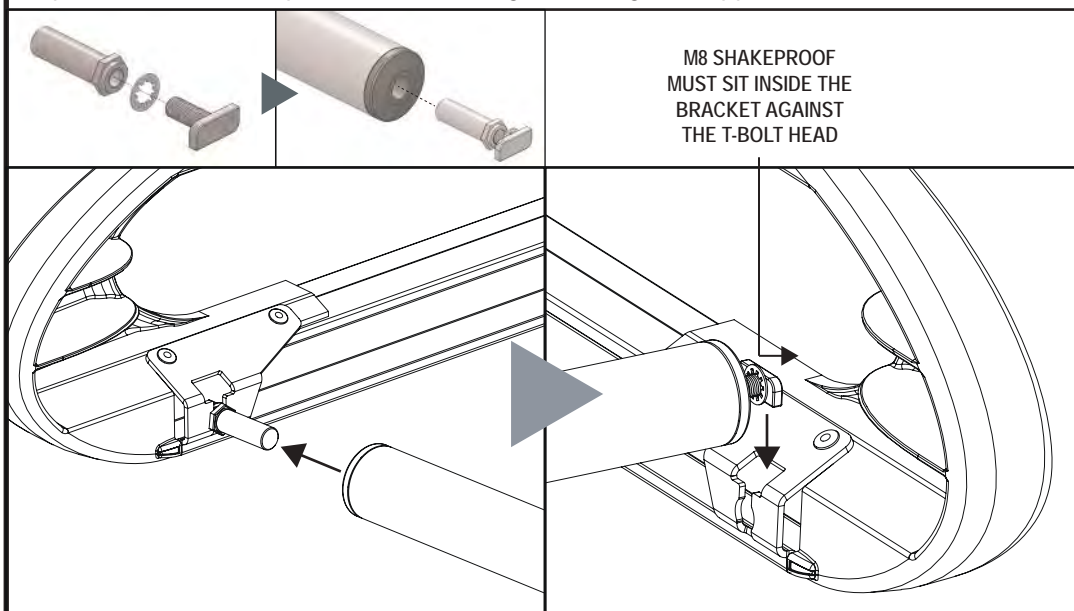

- 18** Push the plastic bungs into position (X4).

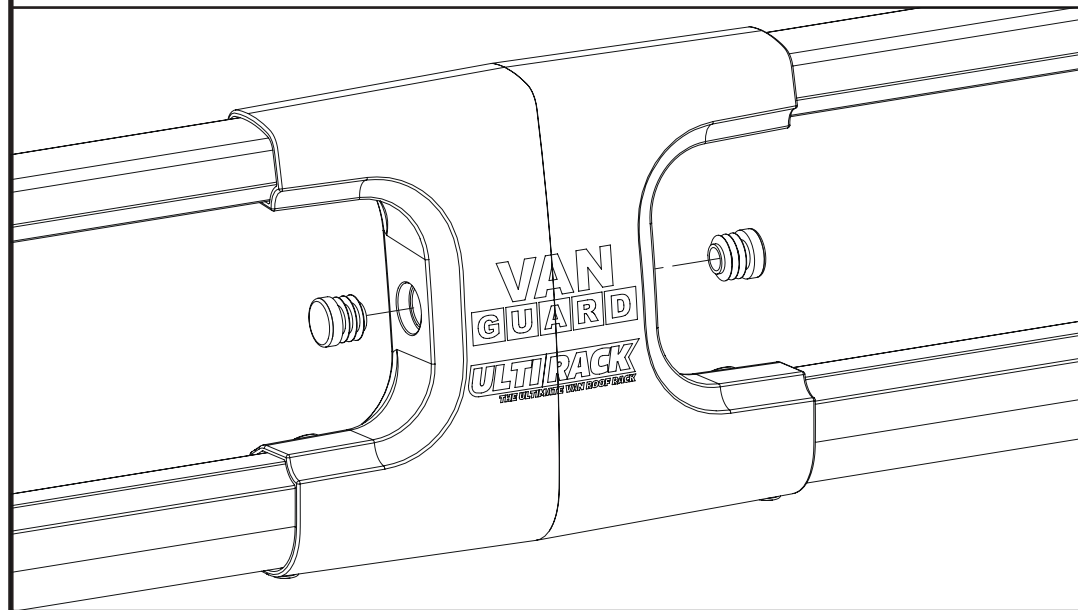

- 19** Check bars are fully secured.

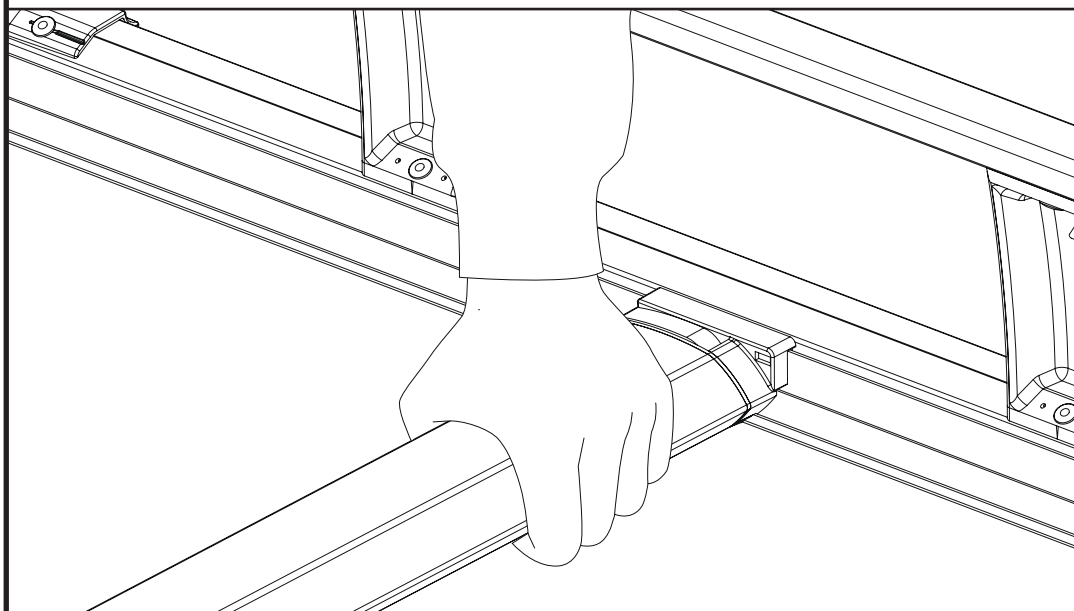

- 20** Once the product has been fitted check fixings and parts to ensure they have been fully secured and tightened. Check fixings and parts at regular intervals. Any damaged or worn parts must be immediately removed from the vehicle and replaced.



**NOTES:**

Maximum load capacity: 150KG (Including rack weight - please refer to page 2.) (Maximum load must be in accordance with the vehicle manufacturer's load bearing capacity. Please refer to the vehicles handbook.). Regularly check all fixings and parts. Retain these instructions for future reference. It is important that the end user receives this document.